

## Mercedes Vito / Viano 08/2005-

Partnr.: MB-070-D1U

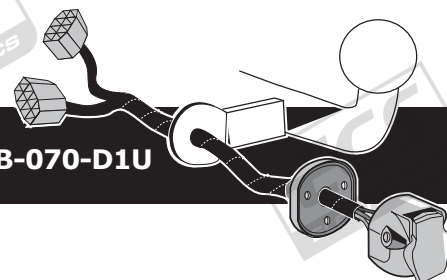

- Fitting instructions electric wiring kit tow bar with 13-P socket up to DIN/ISO Norm 11446.
- We would expressly point out that assembly not carried out properly by a competent installer will result in cancellation of any right to damage compensation, in particular those arising by virtue of the product liability act.
- Contents of these kits and their fitting manuals are subject to alteration without notice, please ensure that these instructions are read and fully understood before commencing installation.
- Do not overload circuits; the maximum loads per connection are detailed in this manual.
- Attention! Before Installation, please read this manual carefully and inform your customer to consult the vehicle owners manual to check for any vehicle modifications required before towing.
- In the event of functional problems, troubleshooting must be limited to about 0.5 hours, contact the technical support:  
[t.skinner@ecs-electronics.com](mailto:t.skinner@ecs-electronics.com) / 07440 202 052.



# Part list

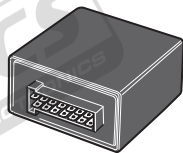
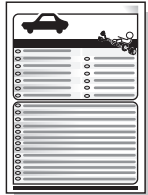
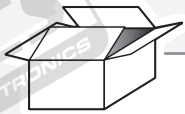

M

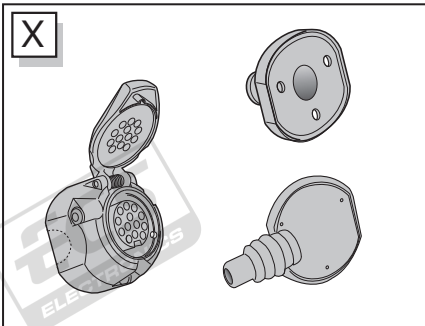

X

M



B1



H	CAN_H	Brown/Red
L	CAN_L	Brown
T	STOP	Blue/Red

X



1x

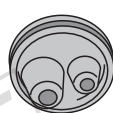

T

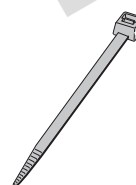

15x

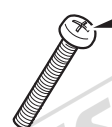

3x



3x

## INFO



## ROUTING

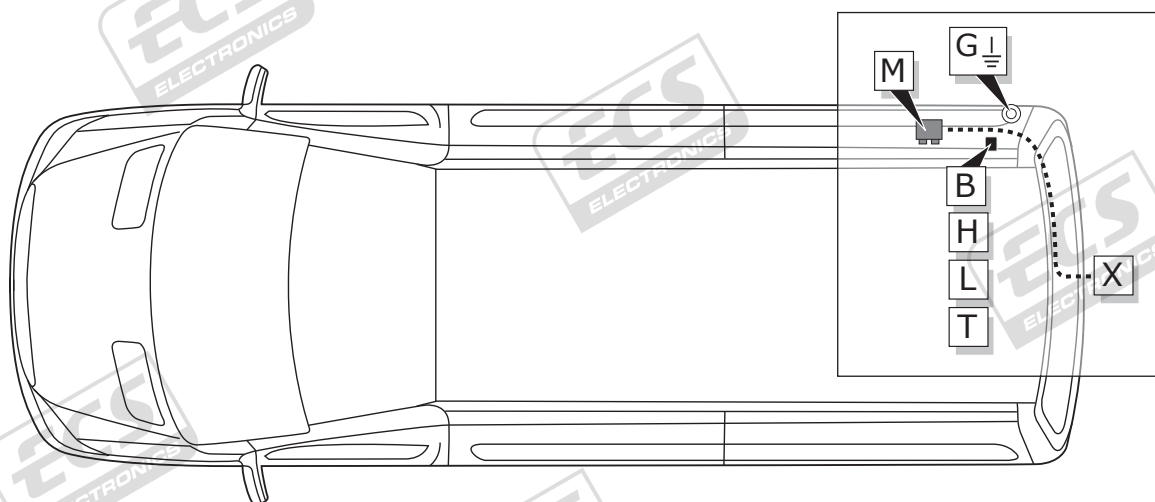

1

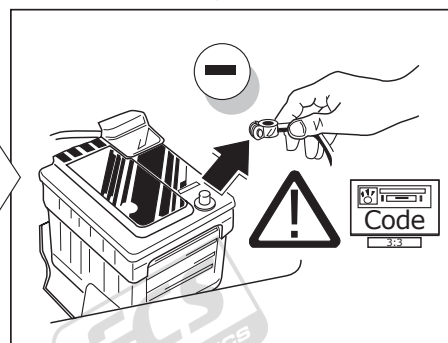
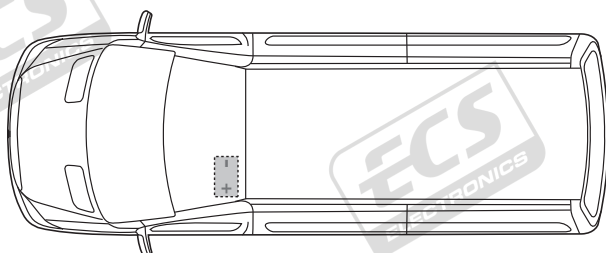

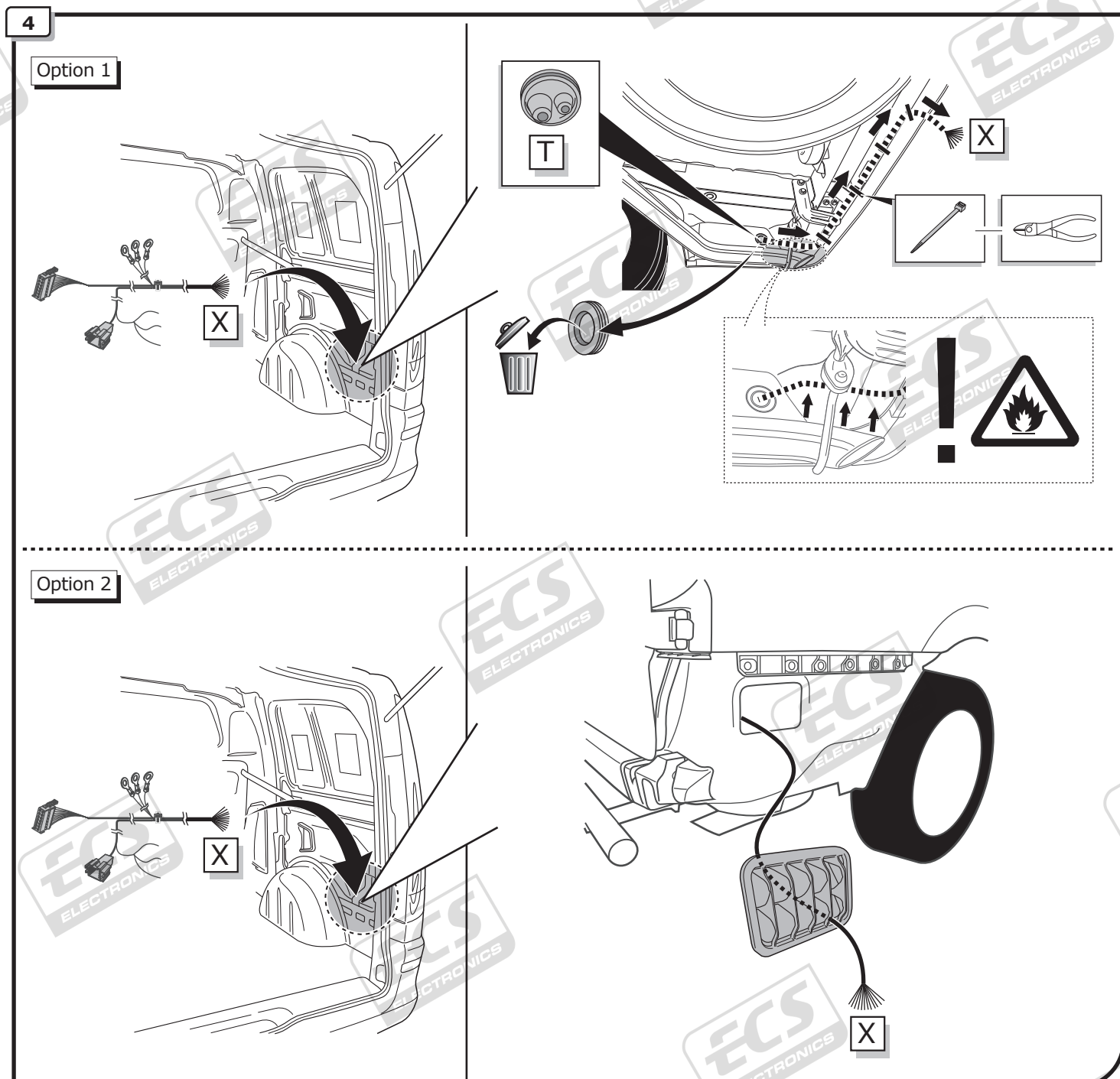
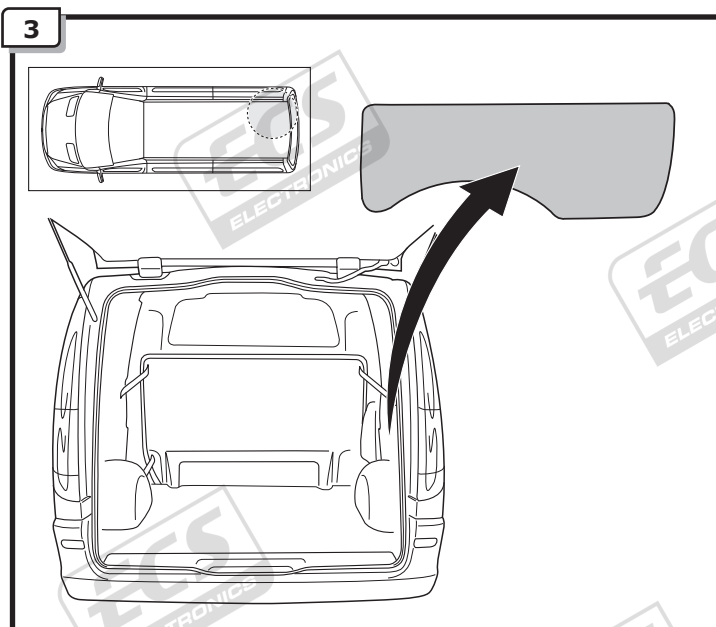
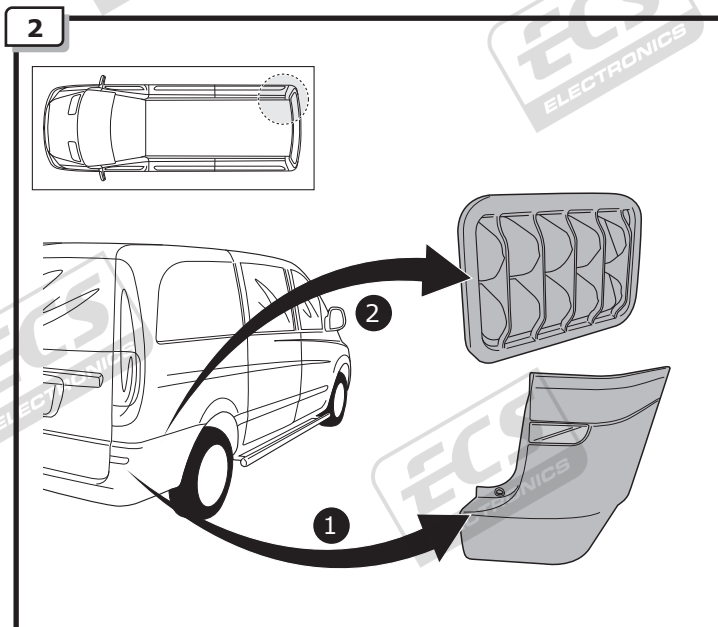

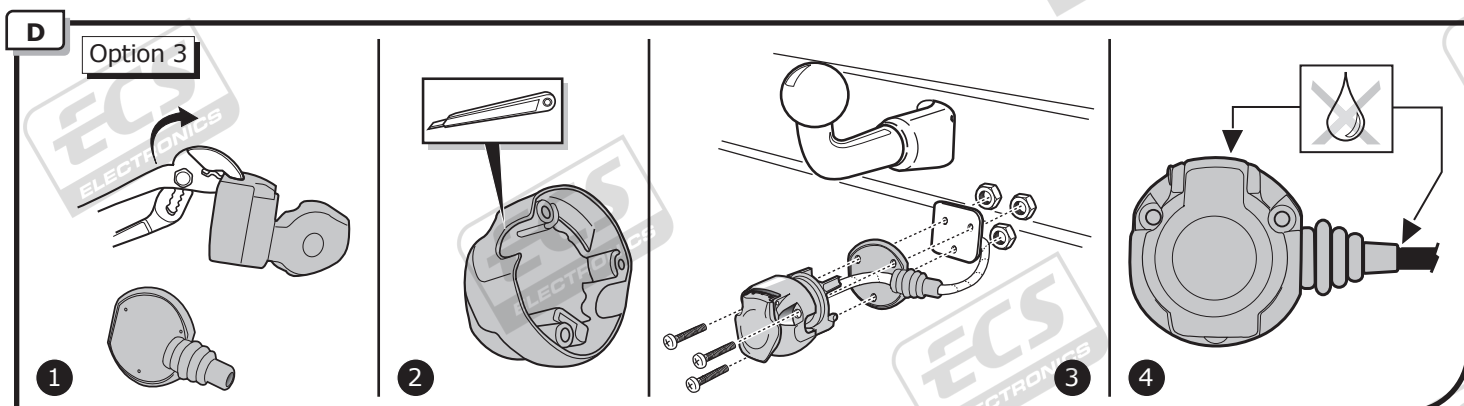
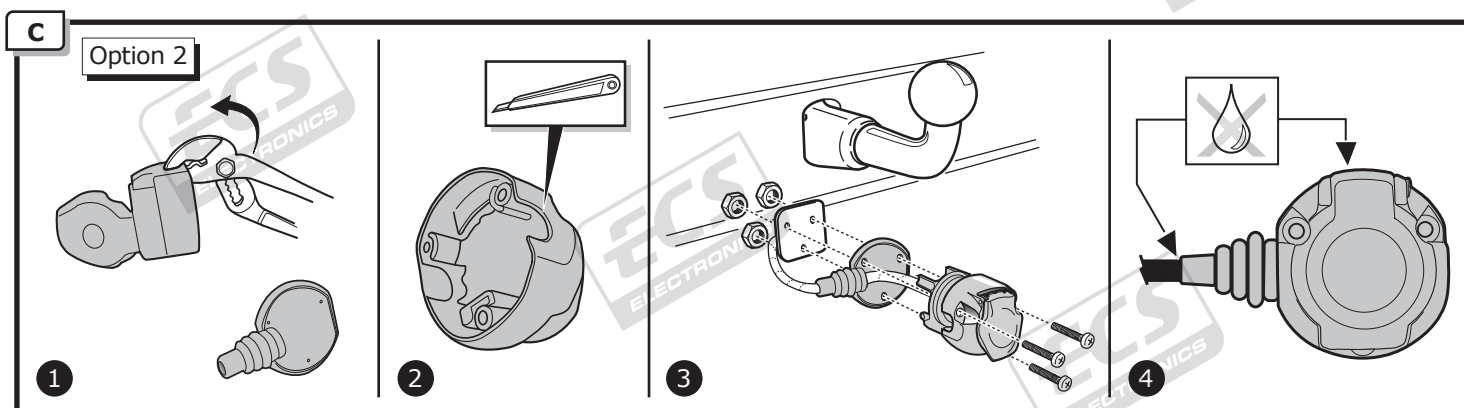
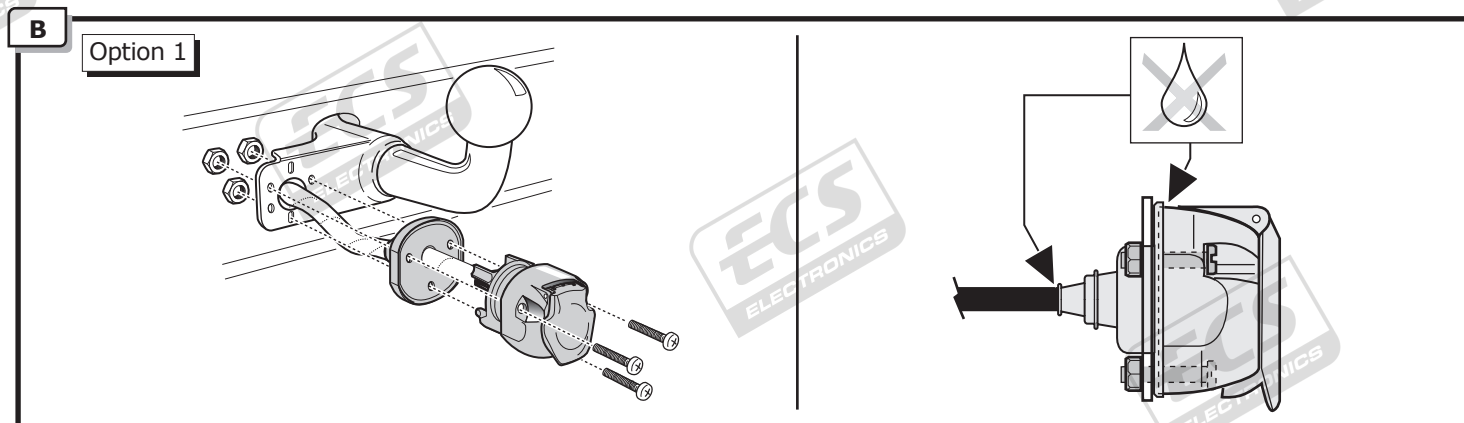
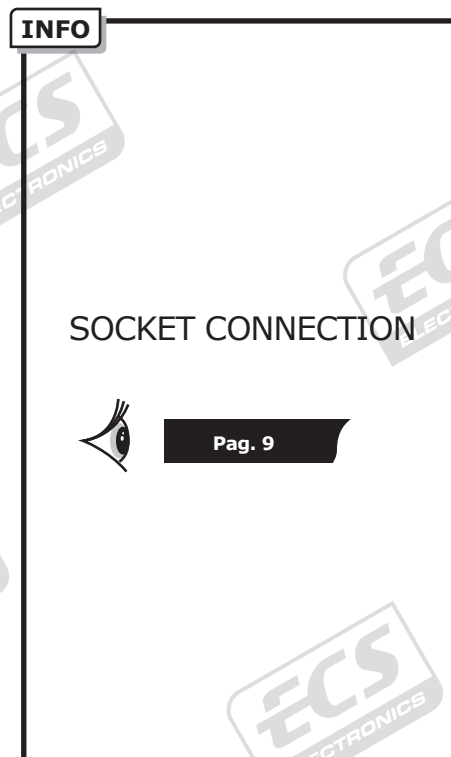
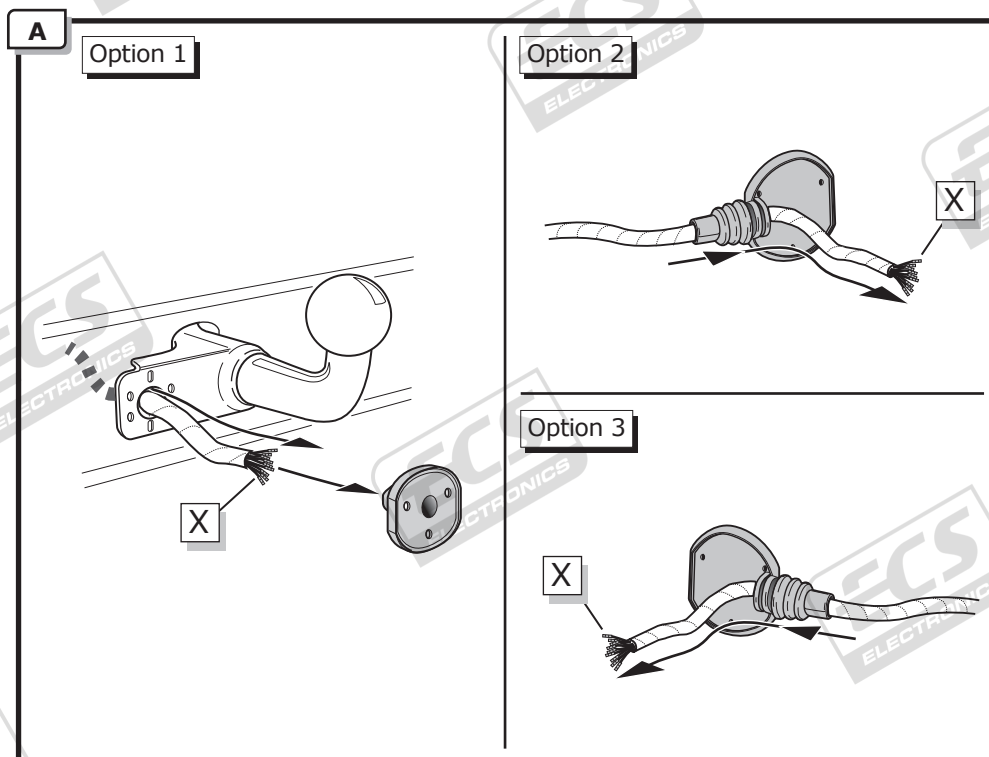



5

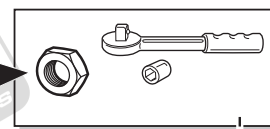
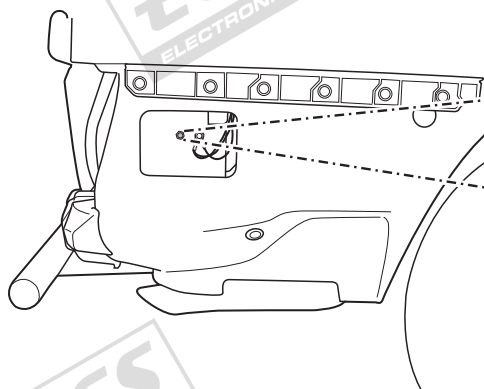
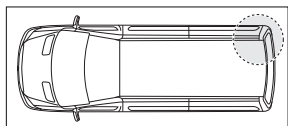

G

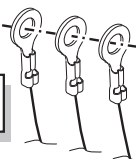

6

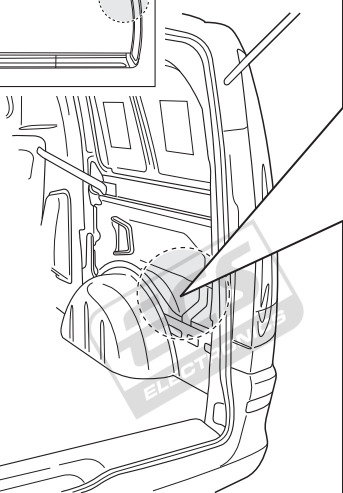
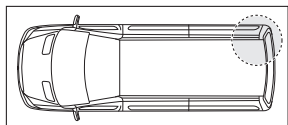

Y

4p.

Z

8p.



7



Y

4p.

Z

8p.



option

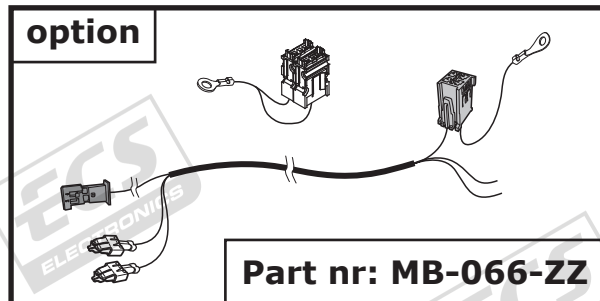

Part nr: MB-066-ZZ



Supplier

7

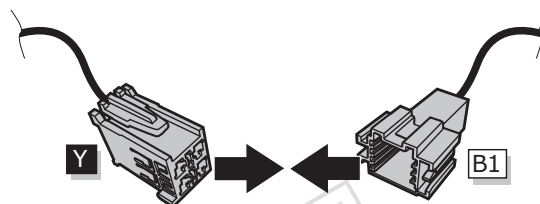
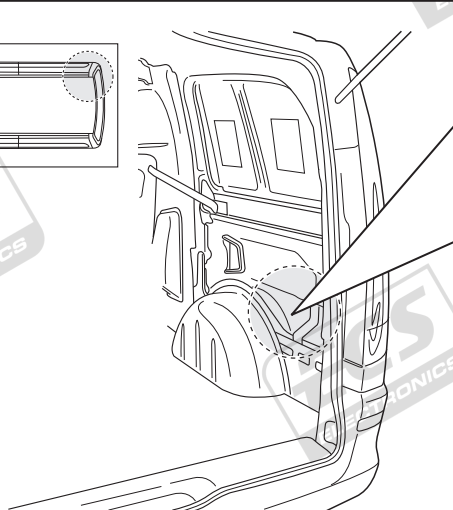
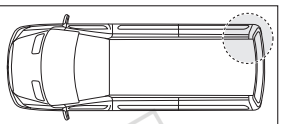

Y

B1

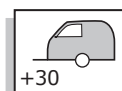

+30

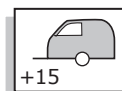

+15

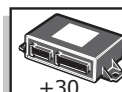

+30

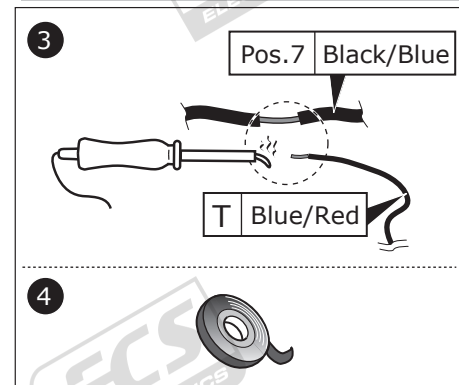
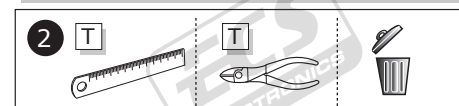
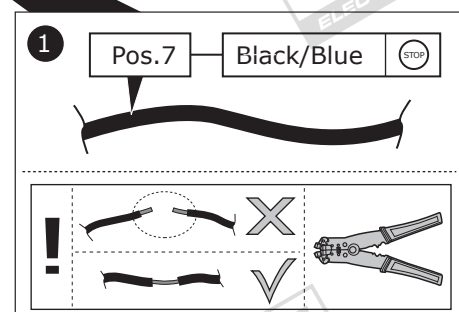
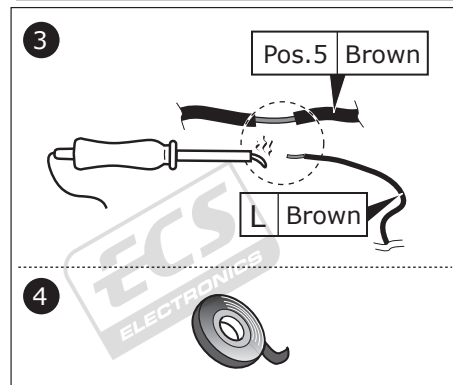
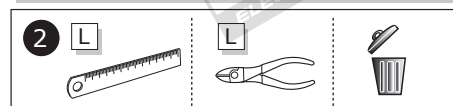
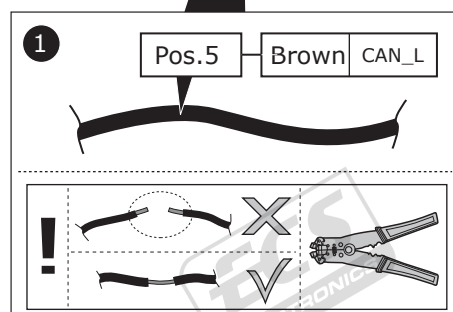
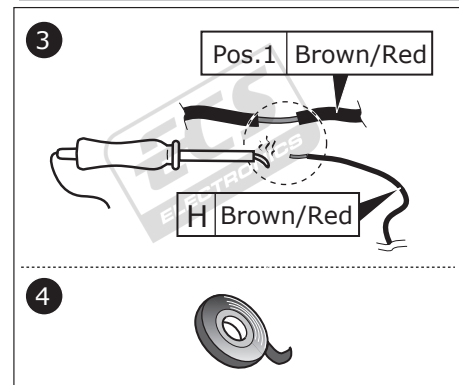
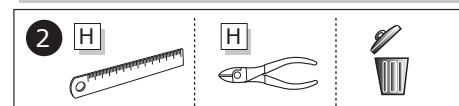
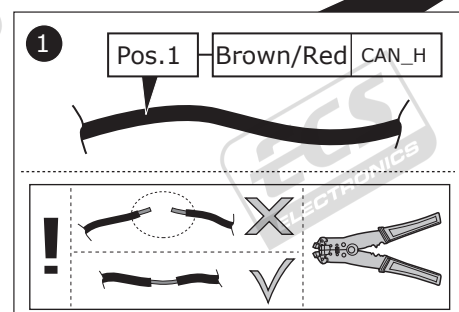
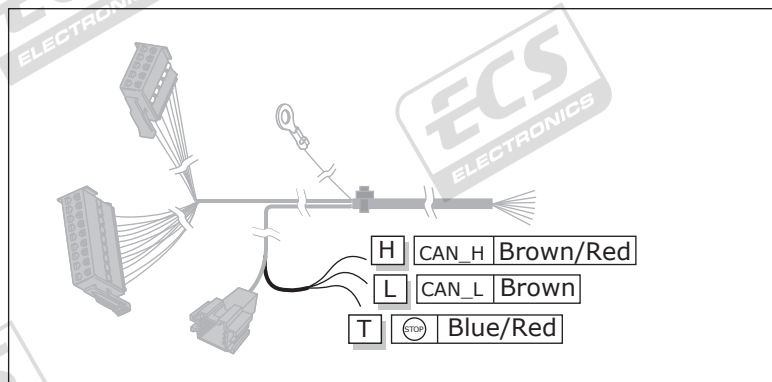
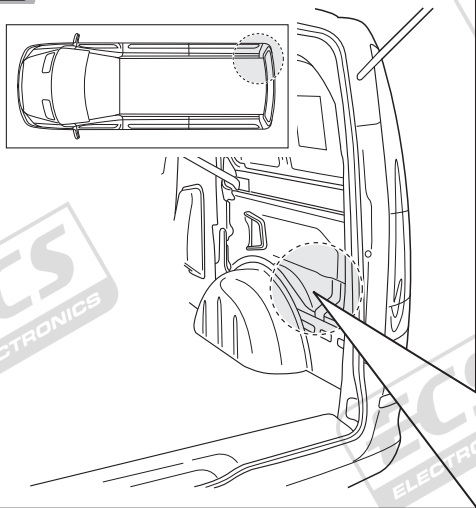

N.B.: To solder and isolate carefully!



9

1

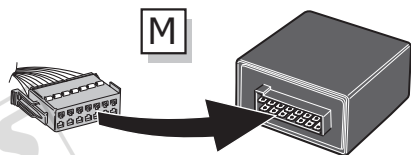

2

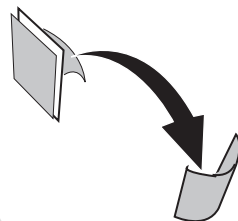
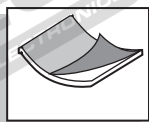

3

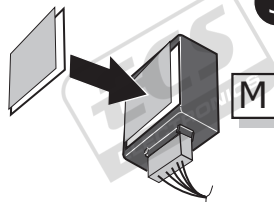

4

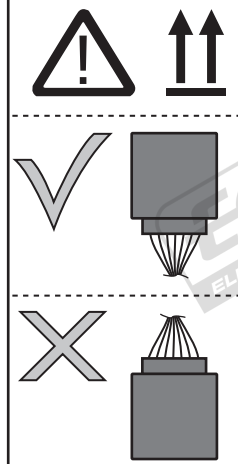
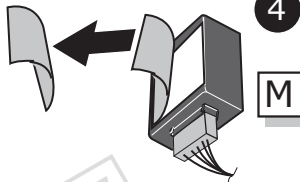

10

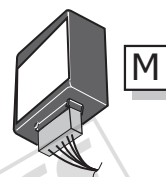
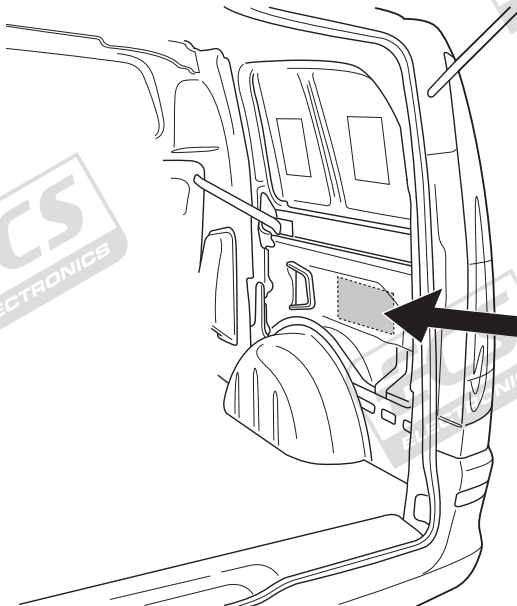
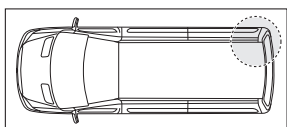

11

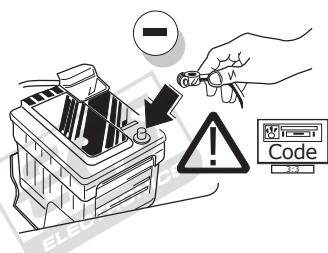

12



TEST ALL THE CIRCUITS WITH A TEST DEVICE WITH THE CORRECT POWER LOAD FOR EACH FUNCTION. A TEST DEVICE WITH LED'S CANNOT BE USED FOR THIS PURPOSE.



REINSTALL TRIM.



## SOCKET CONNECTION

DIN/ISO 11446													
	1/L	2	3/31	4/R	5/58-R	6/54	7/58-L	8	9	10	11	12	13
Pmax	21W	2x21W		21W	52W	3x21W	52W	2x21W	180W/15Amp	180W/15Amp			
Colour	Yellow	Blue	White	Green	Brown	Red 1,00 mm <sup>2</sup>	Black	Black/ Red	Brown/ White	Red 2,50 mm <sup>2</sup>	White	-	White