

## Skoda Yeti 2010-

Partnr.: SK-015-B2U

- Fitting instructions electric wiring kit tow bar with 12-N socket up to DIN/ISO Norm 1724.
- We would expressly point out that assembly not carried out properly by a competent installer will result in cancellation of any right to damage compensation, in particular those arising by virtue of the product liability act.
- Contents of these kits and their fitting manuals are subject to alteration without notice, please ensure that these instructions are read and fully understood before commencing installation.
- Do not overload circuits; the maximum loads per connection are detailed in this manual.
- Attention! Before Installation, please read this manual carefully and inform your customer to consult the vehicle owners manual to check for any vehicle modifications required before towing.
- In the event of functional problems, troubleshooting must be limited to about 0.5 hours, contact the technical support:  
[t.skinner@ecs-electronics.com](mailto:t.skinner@ecs-electronics.com) / 07440 202 052.



# Part list

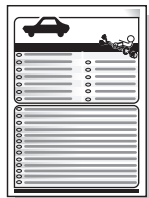
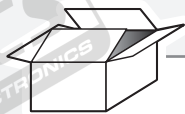

U2

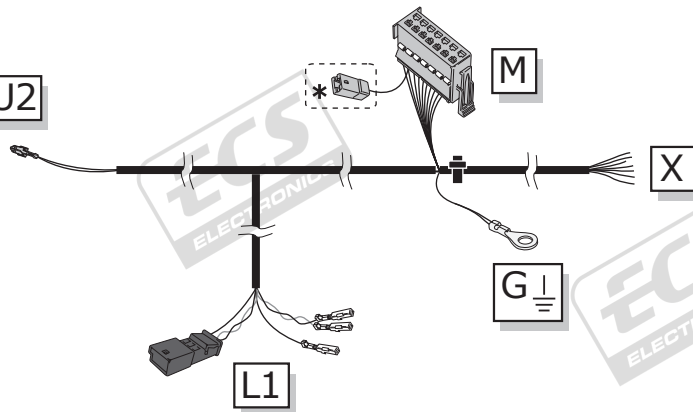

M

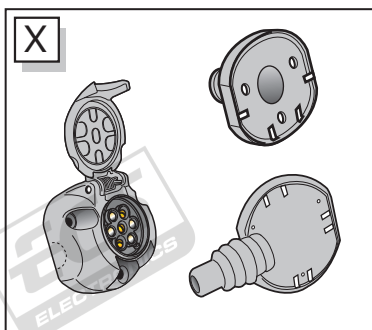

X

U2

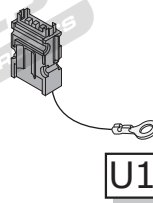

U1

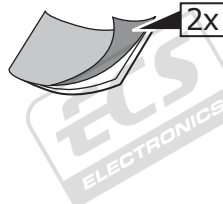

2x

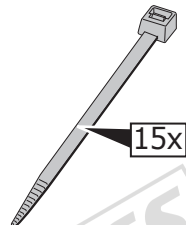

15x



T

\* Reverse signal preparation  
 Pag. 13

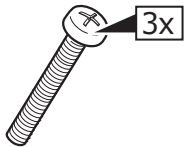

3x

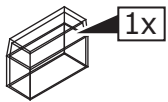

1x



1x



3x

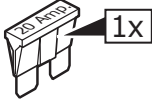

1x

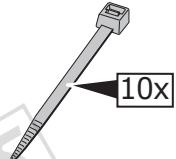

10x

## ROUTING

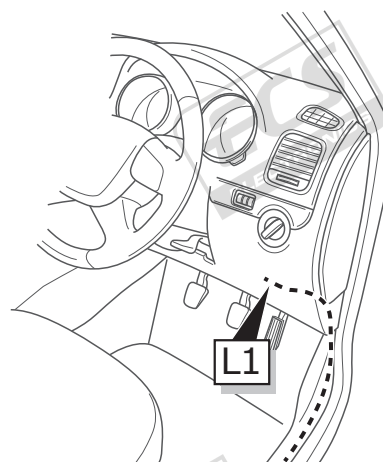
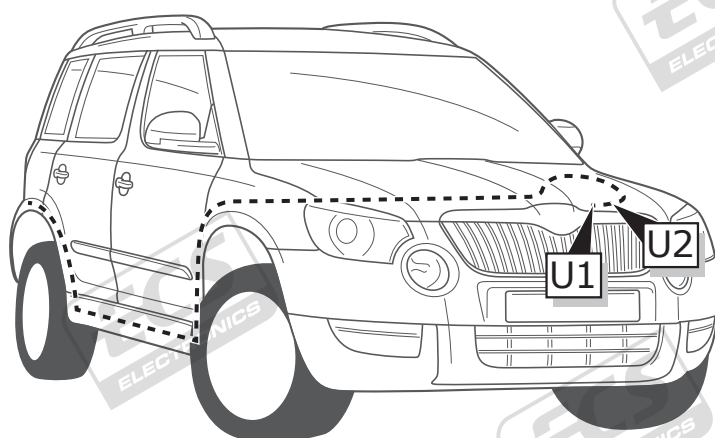
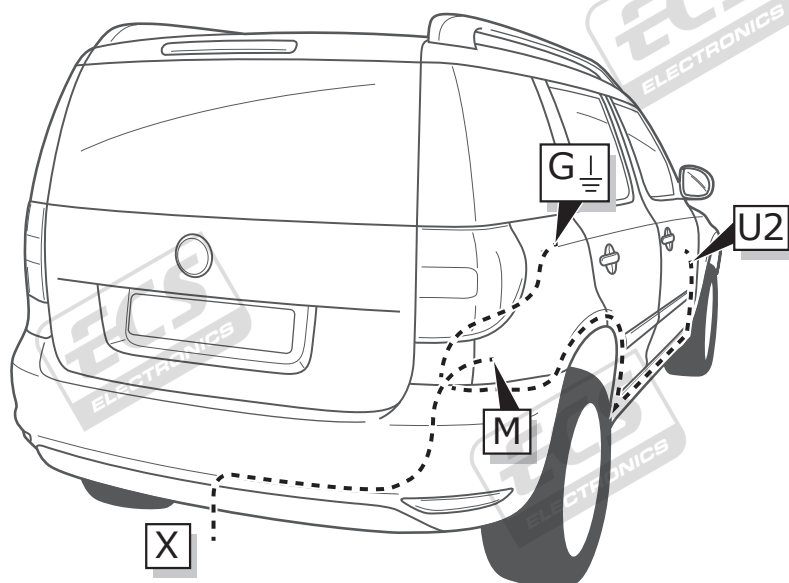

1

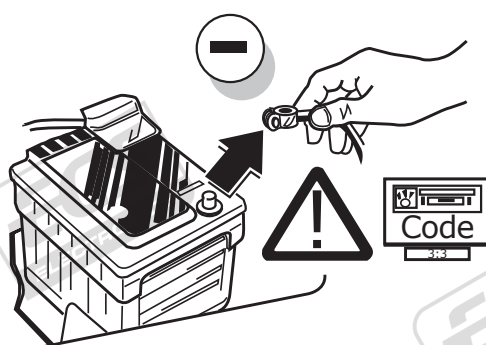

2

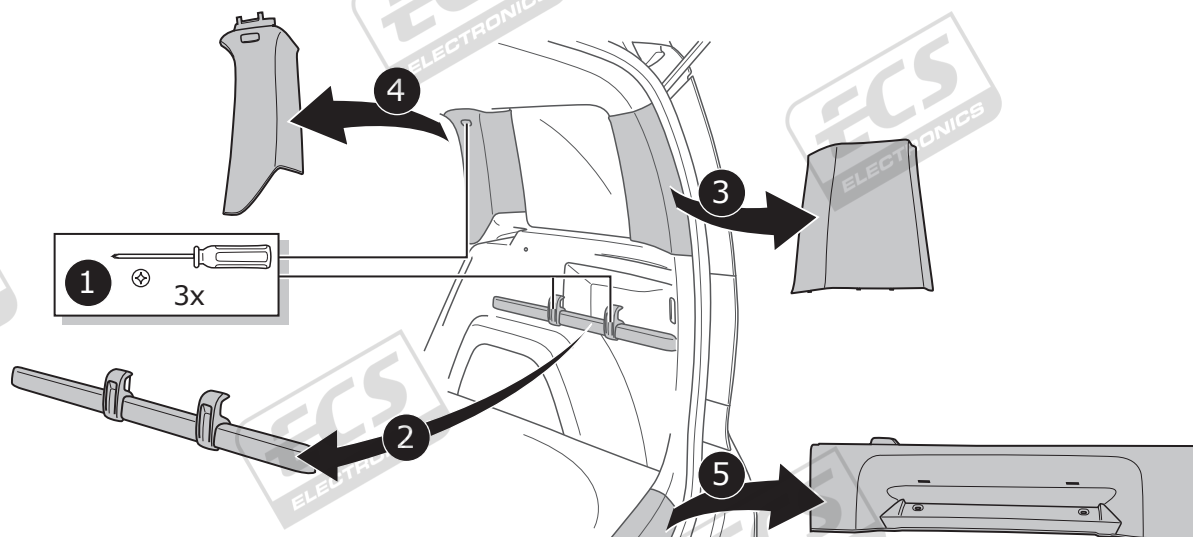

3

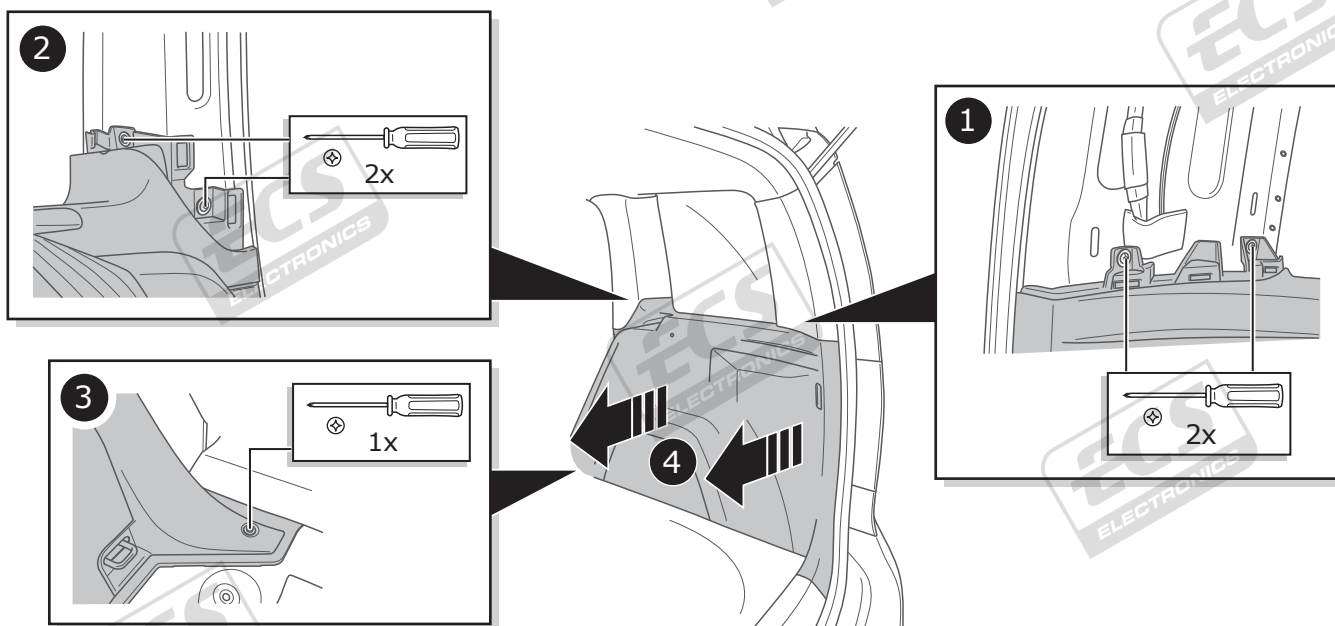

4

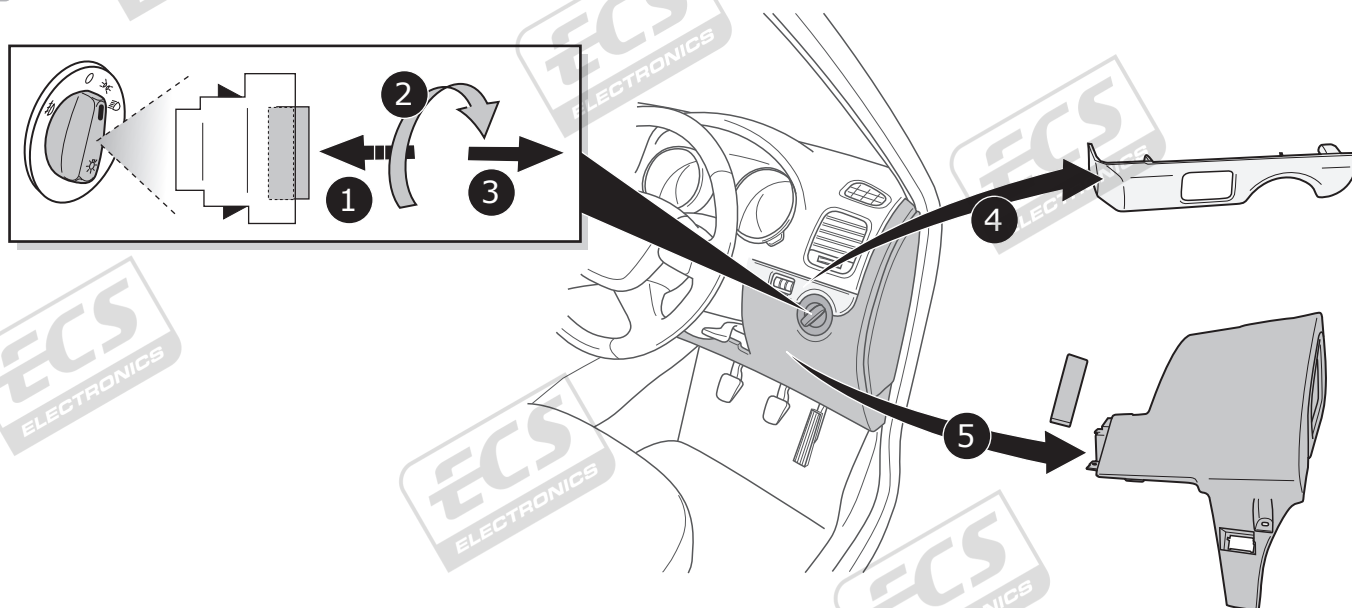

5

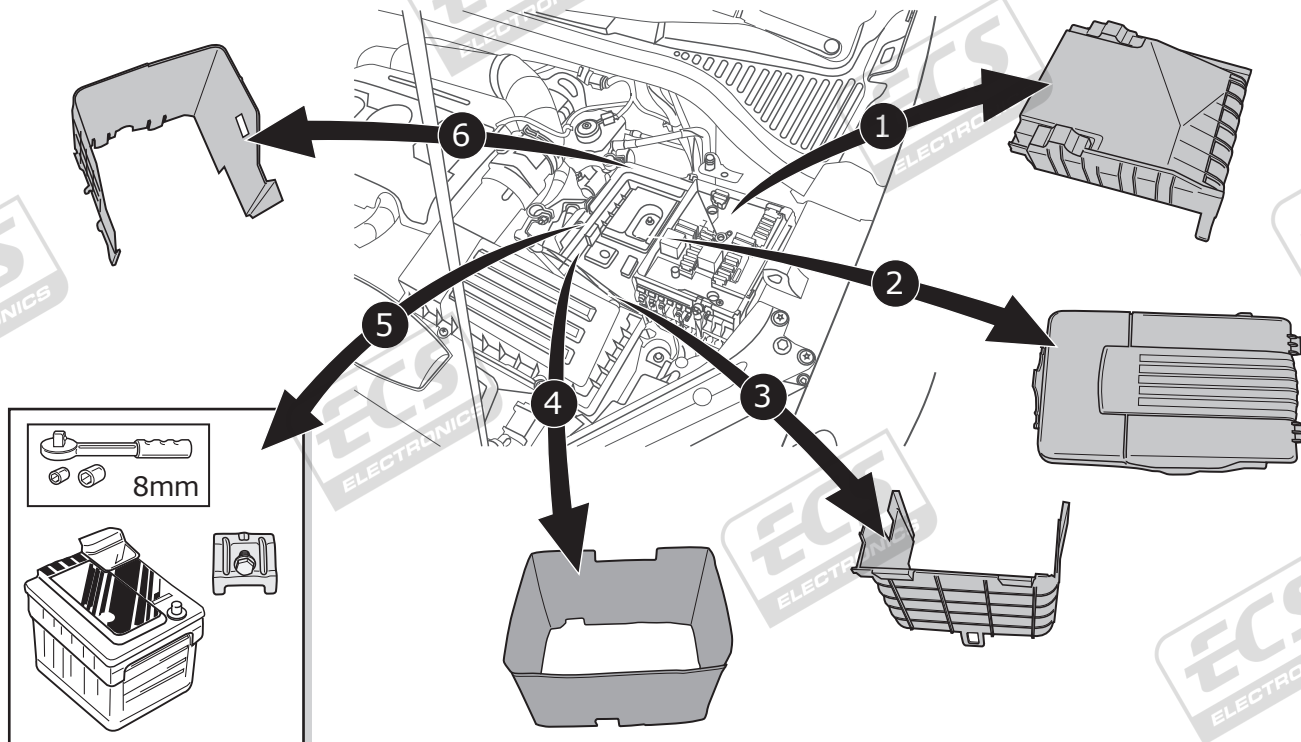

6

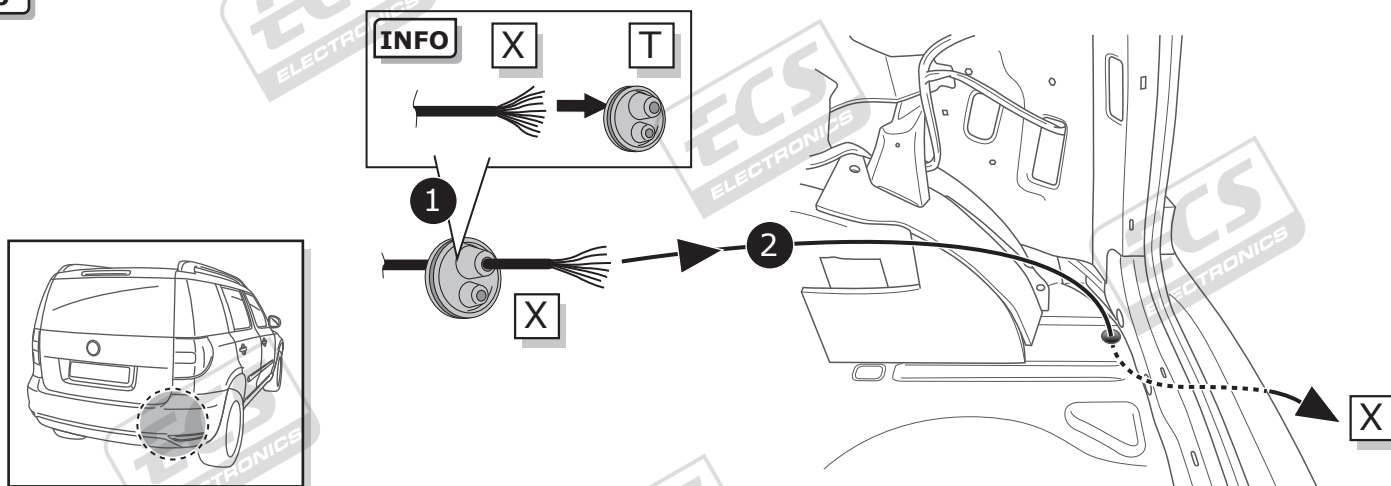

A

Option 1

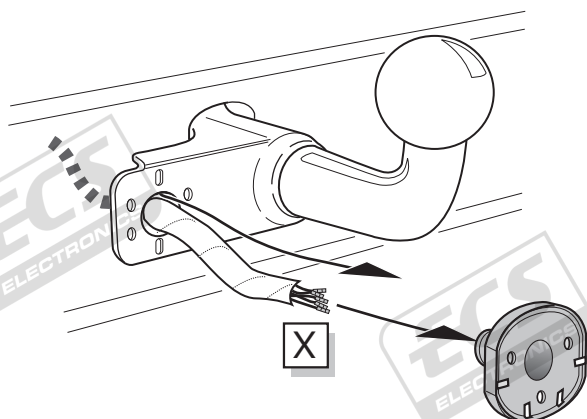

Option 2

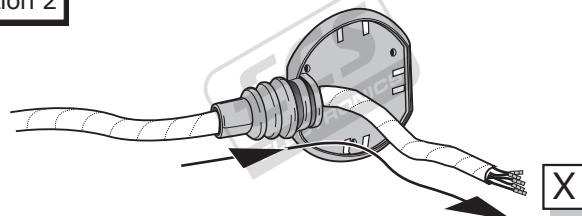

Option 3

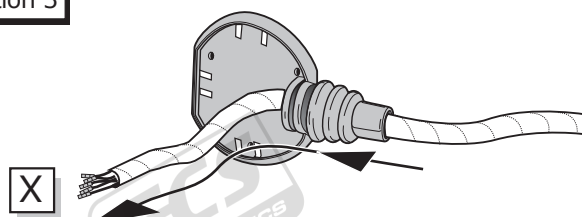



# SOCKET CONNECTION



Pag. 12

B

Option 1

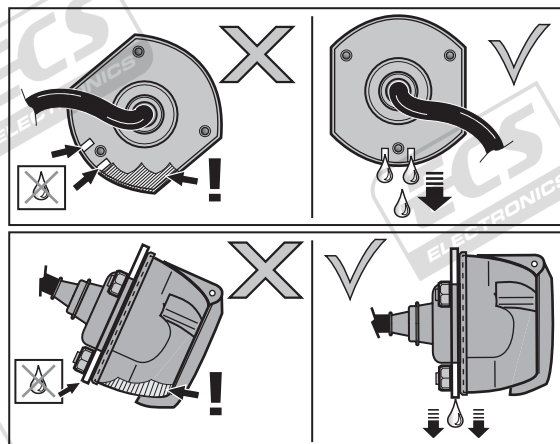
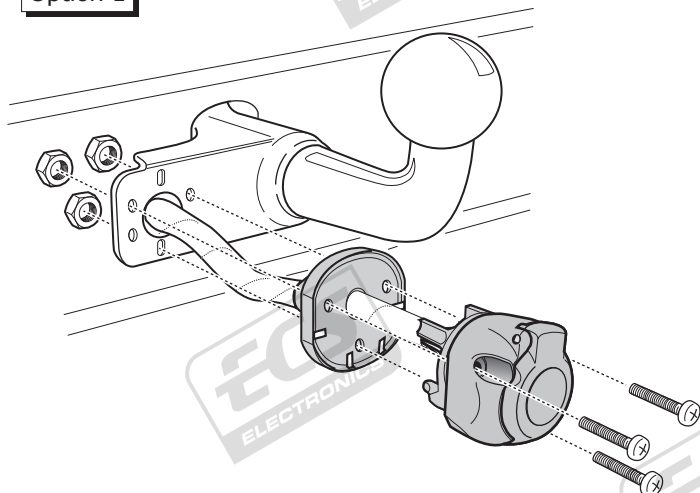

C

Option 2

1

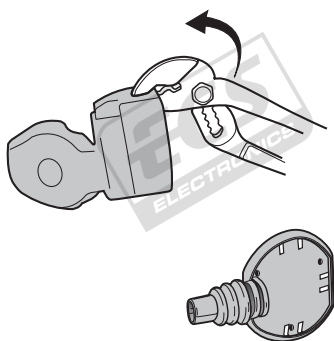

2

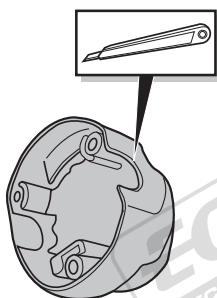

3

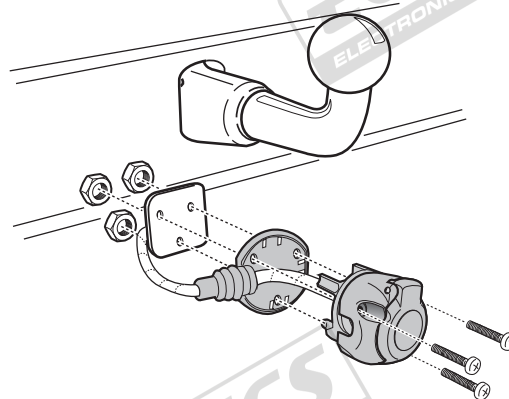

D

Option 3

1

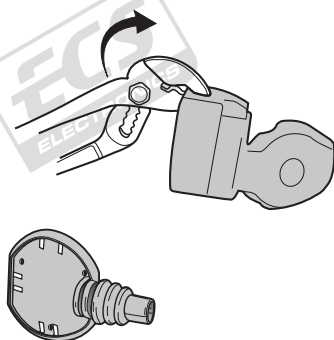

2

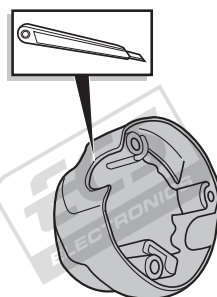

3

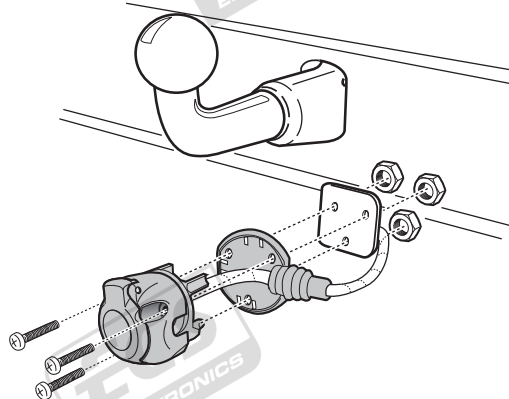

7

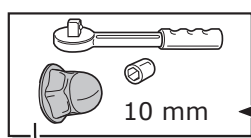
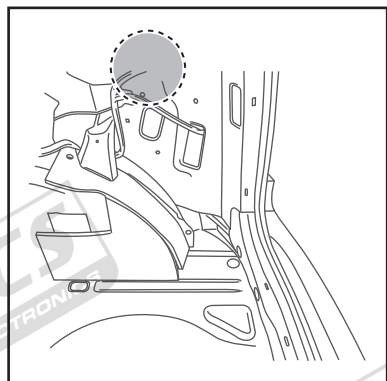

1

2

8

1

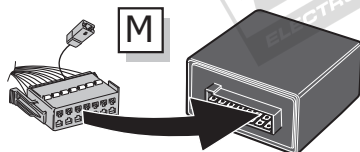

2

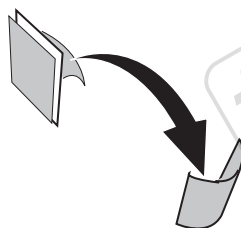
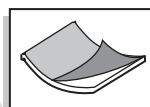

3

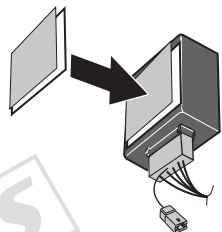

M

4

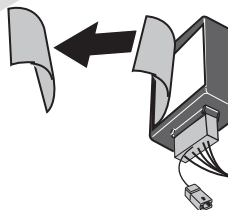

M

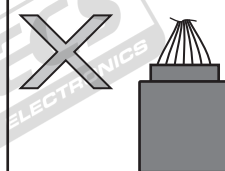
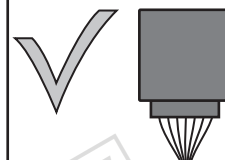

9

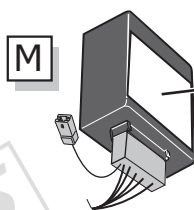

10

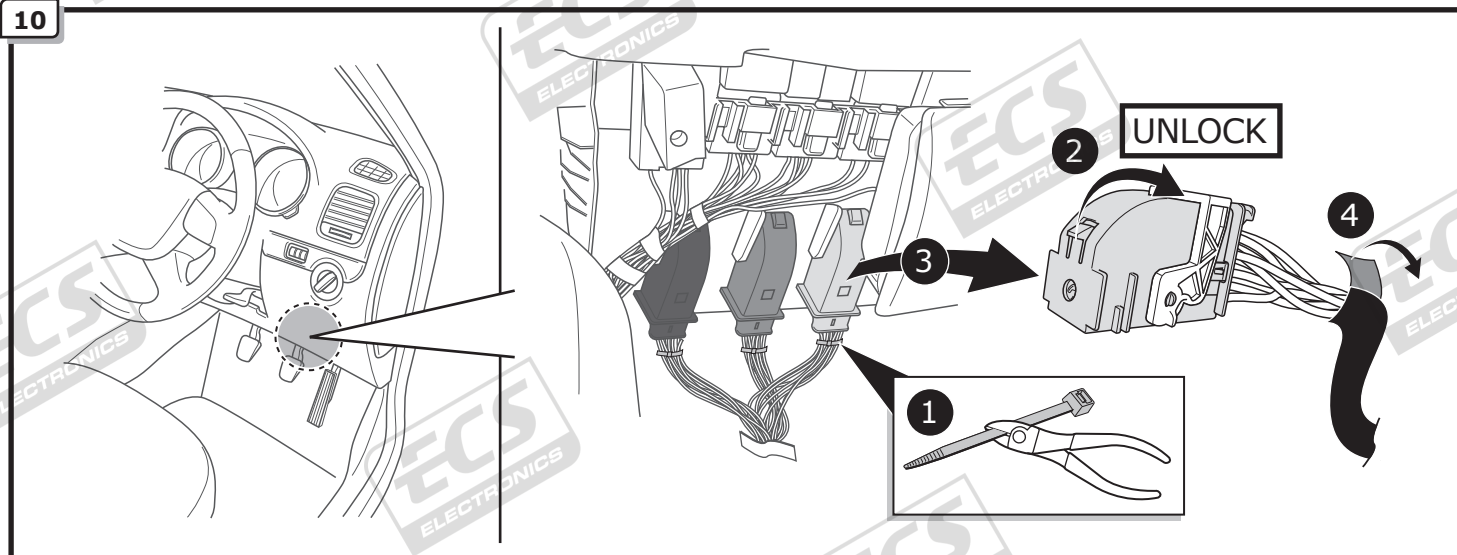

11

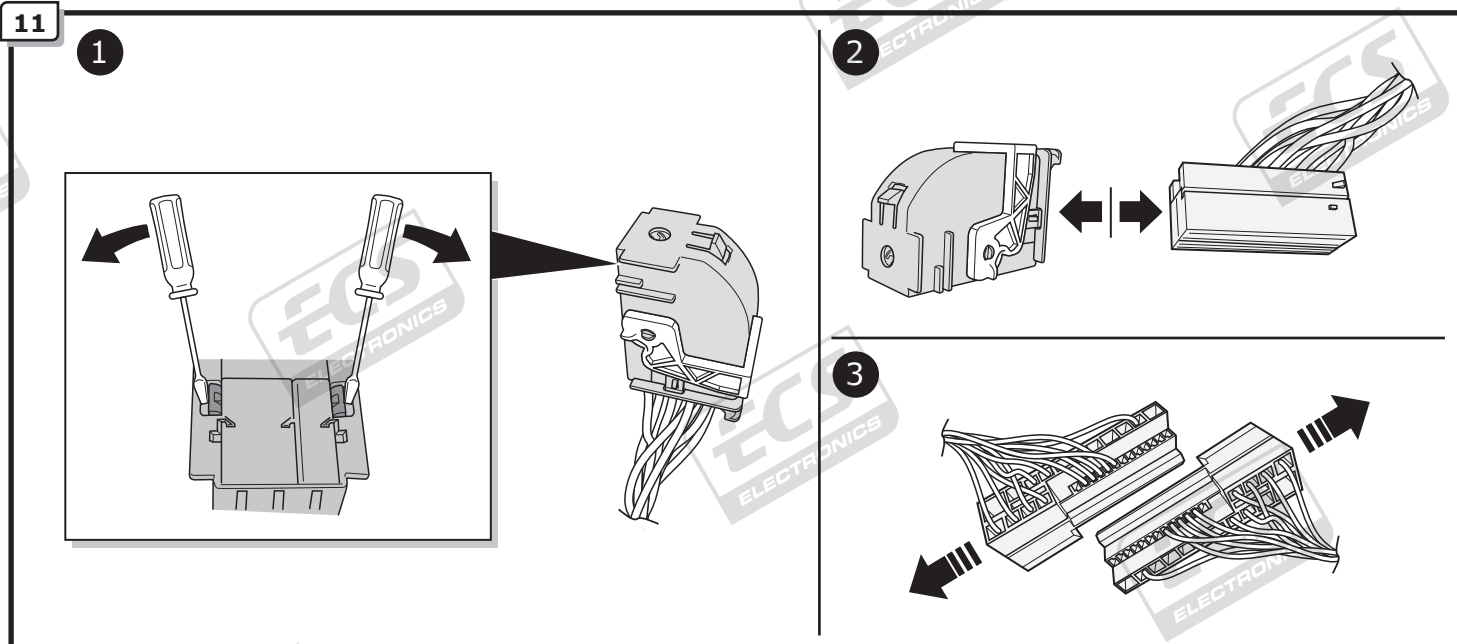

12

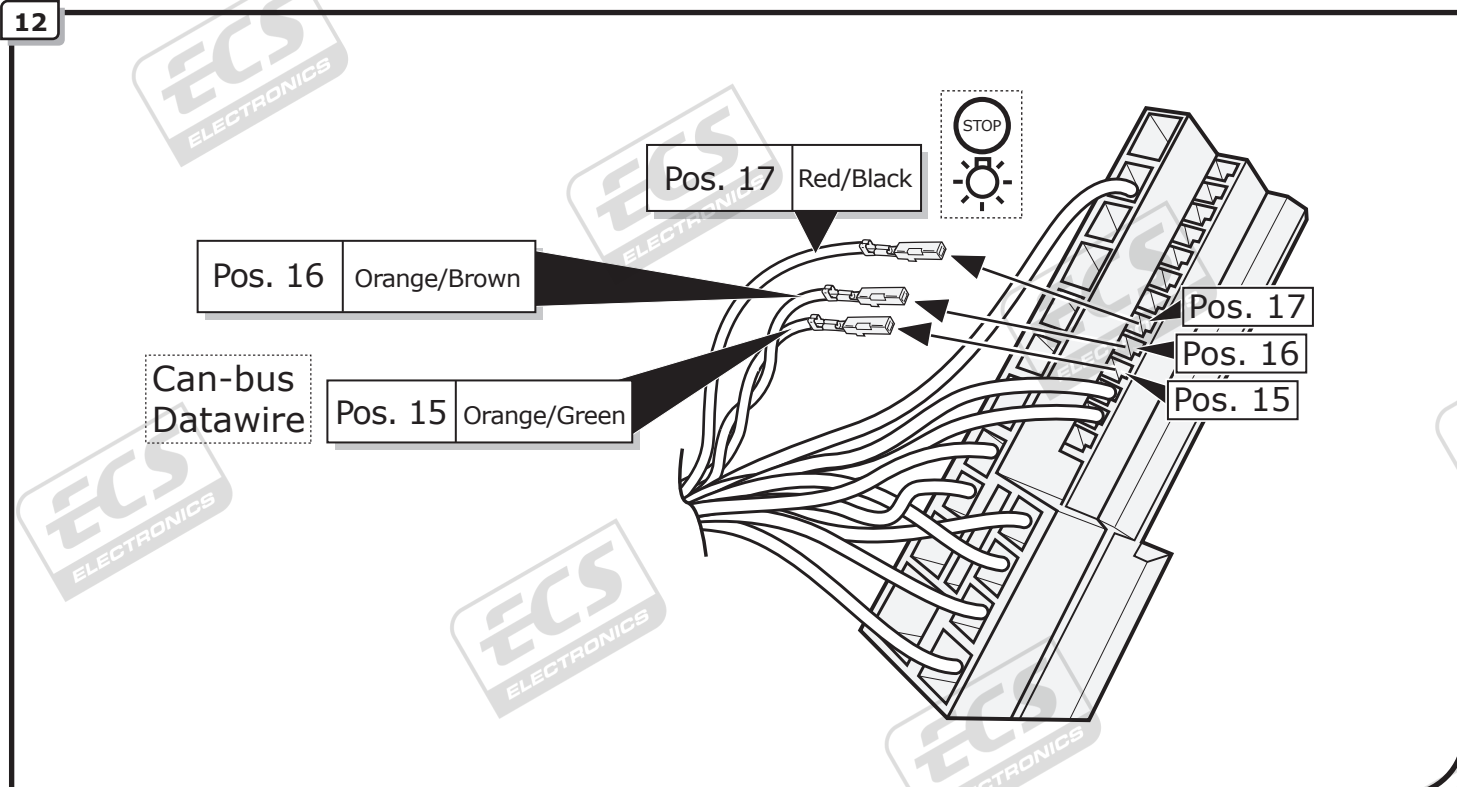



13

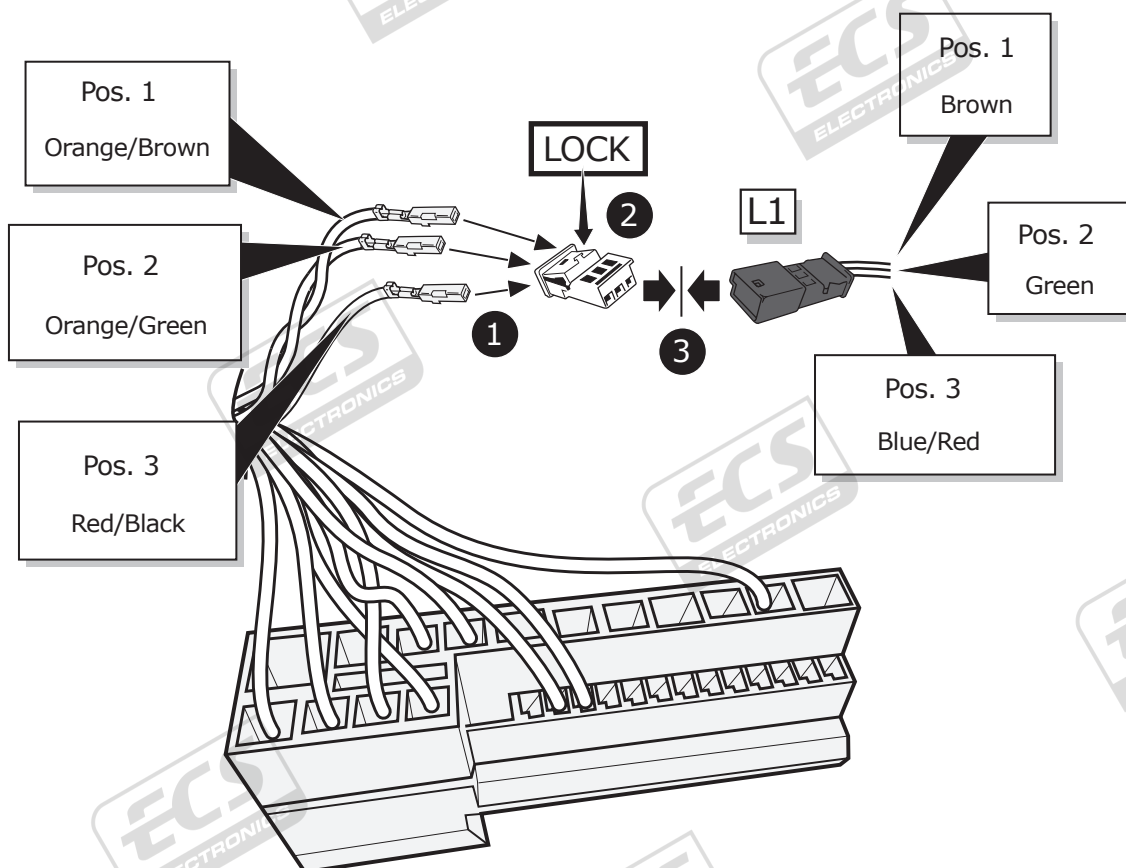

14

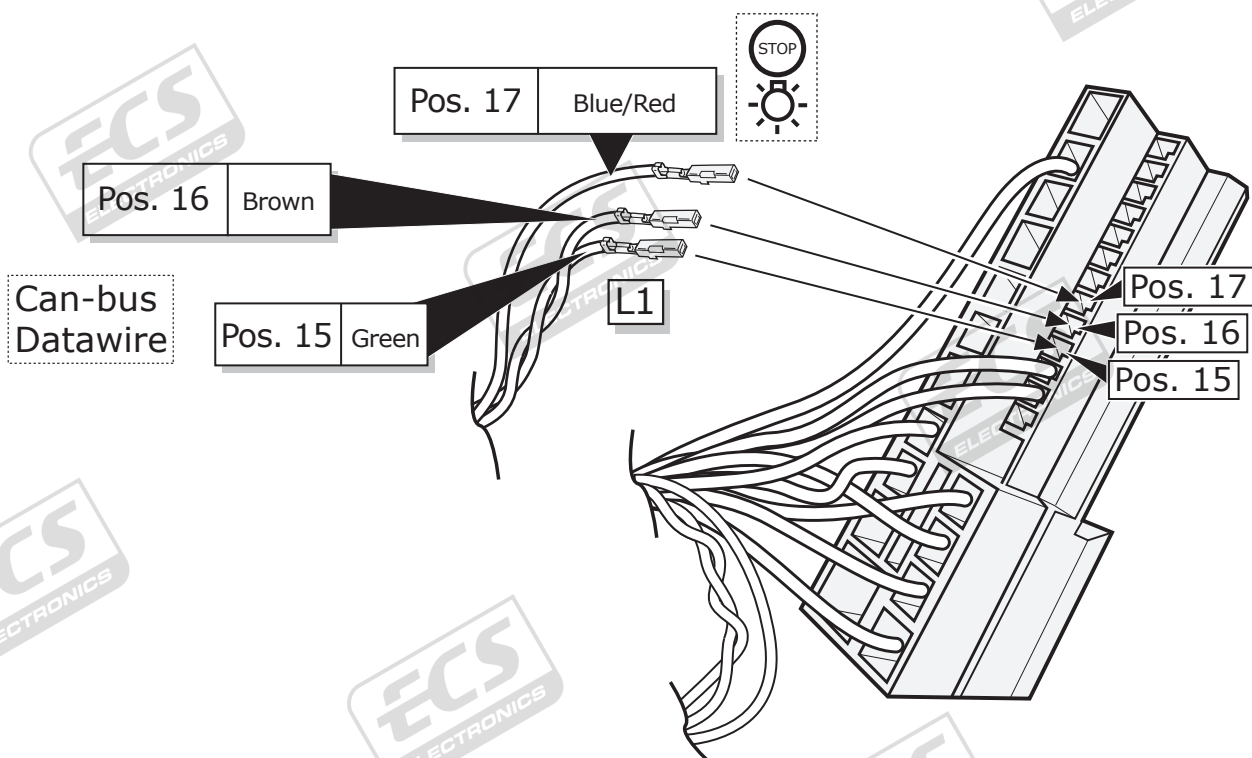

15

1

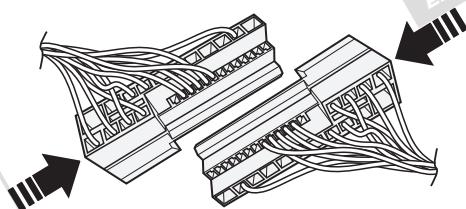

2

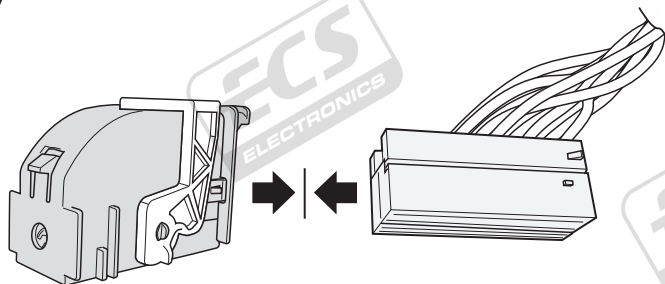

16

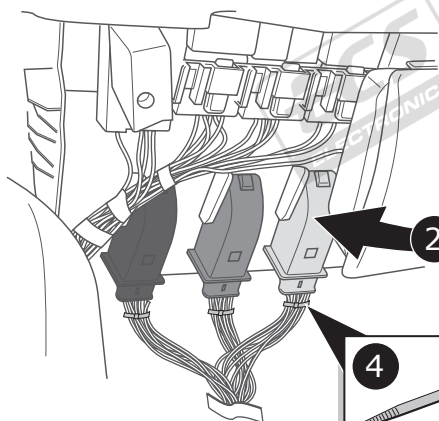
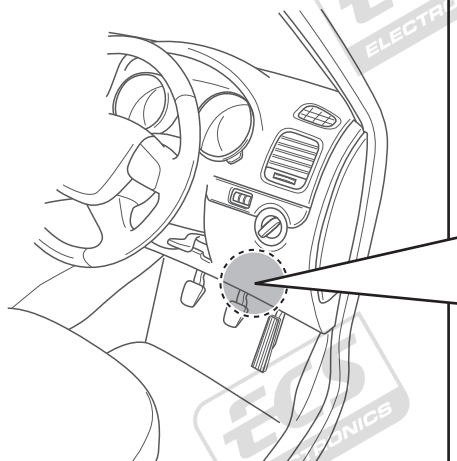

3

LOCK

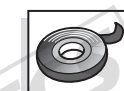
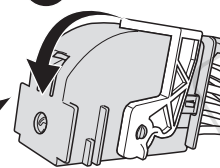

1

4

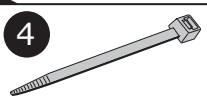

17

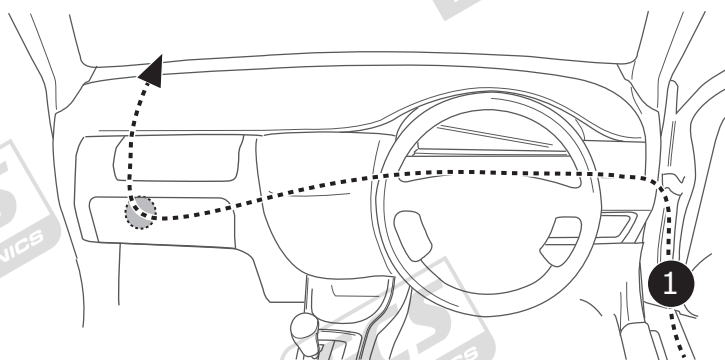

1

U2

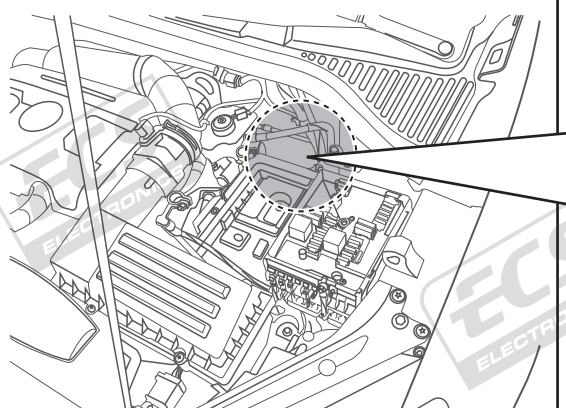

SEAL WITH SILICONE.



4

2

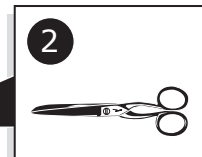

3

U2

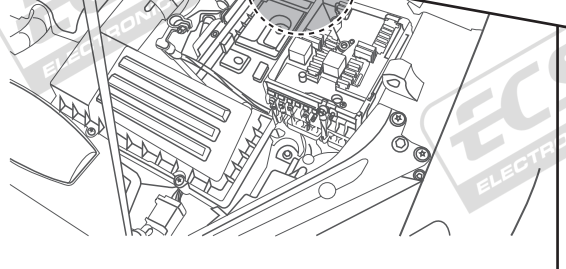

18

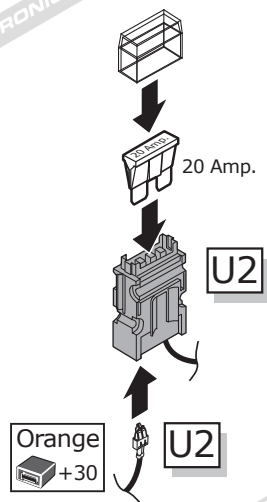
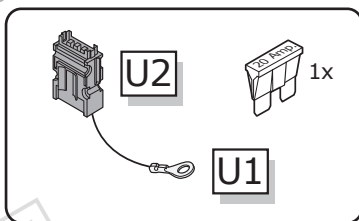

19

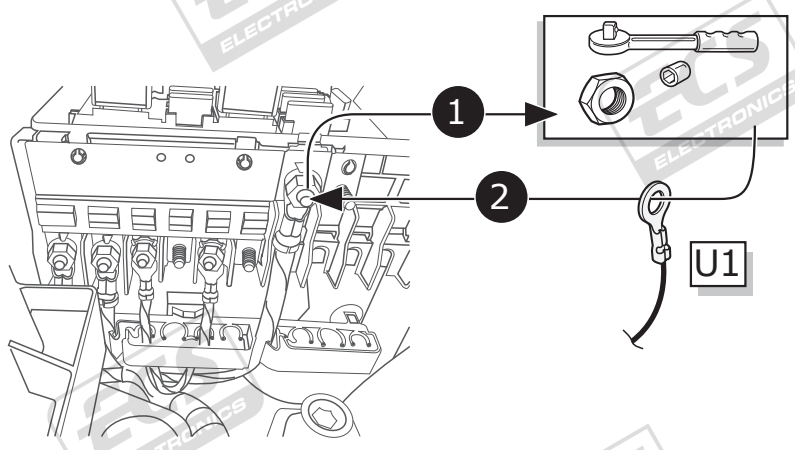
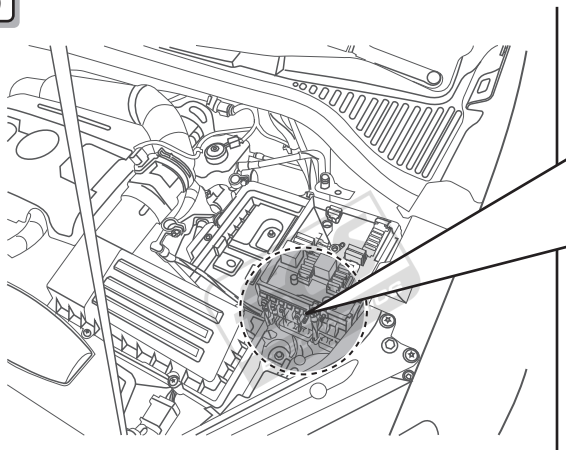

20

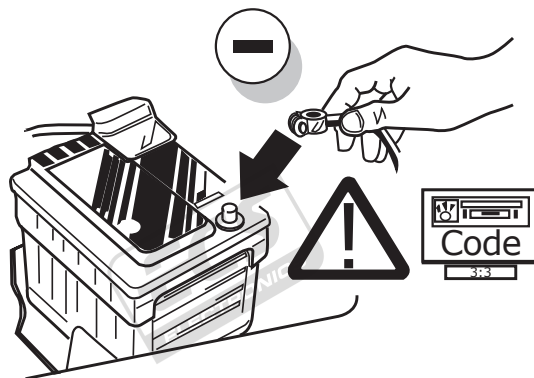

21

A VAG Service Tester must be used to code the vehicle's Gateway with the additional function for the towing hitch at the dealer.

**!** TEST ALL THE CIRCUITS WITH A TEST DEVICE WITH THE CORRECT POWER LOAD FOR EACH FUNCTION. A TEST DEVICE WITH LED'S CANNOT BE USED FOR THIS PURPOSE.

## INFO

REINSTALL TRIM.

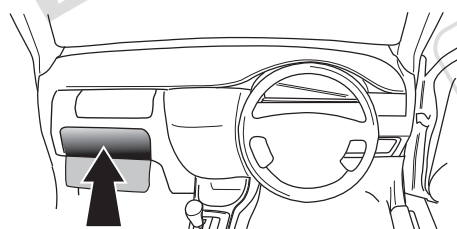

**User guide**



## INFO

### SOCKET CONNECTION

DIN/ISO 1724	↶	🚗🔊	⏏ 1-7	↷	☀	⊞	☀
	1/L	2	3/31	4/R	5/58-R	6/54	7/58-L
Pmax	21W	21W		21W	42W	3x21W	42W
Colour	Black/White	Blue	Brown	Black/Green	Grey/Red	Black/Red	Grey/Black

## Reverse signal preparation

A

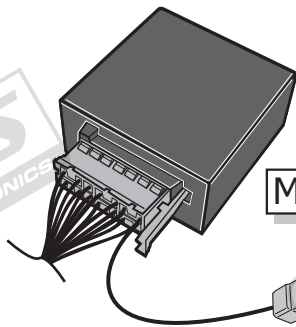

1

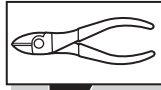

2



B

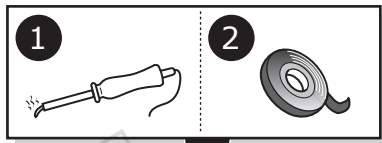

2



⚠ MAX = 21W

Reverse

