

**Ford Mondeo Sedan, Hatchback, Stationwagon 06/2007-
Ford S-Max 03/2006-
Ford Galaxy 06/2006-**

Partnr.: FR-051-B1U

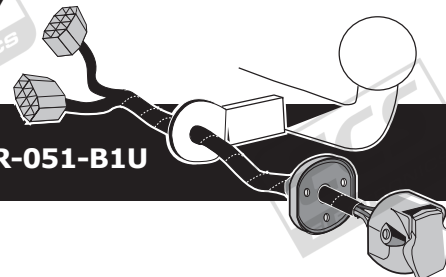

- Fitting instructions electric wiring kit tow bar with 12-N socket up to DIN/ISO Norm 1724.
- We would expressly point out that assembly not carried out properly by a competent installer will result in cancellation of any right to damage compensation, in particular those arising by virtue of the product liability act.
- Contents of these kits and their fitting manuals are subject to alteration without notice, please ensure that these instructions are read and fully understood before commencing installation.
- Do not overload circuits; the maximum loads per connection are detailed in this manual.
- Attention! Before Installation, please read this manual carefully and inform your customer to consult the vehicle owners manual to check for any vehicle modifications required before towing.
- In the event of functional problems, troubleshooting must be limited to about 0.5 hours, contact the technical support:
t.skinner@ecs-electronics.com / 07440 202 052.



Part list

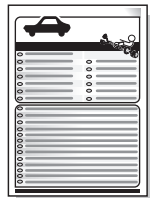
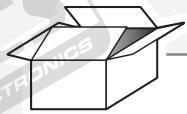

R1

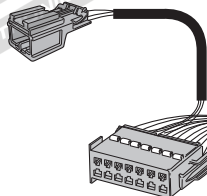

M

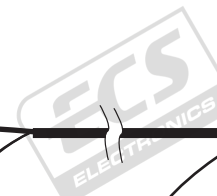

G

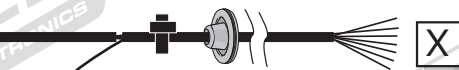

X

U1

U2

M

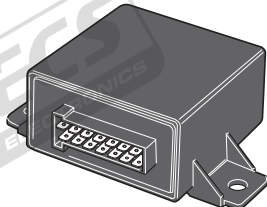

X

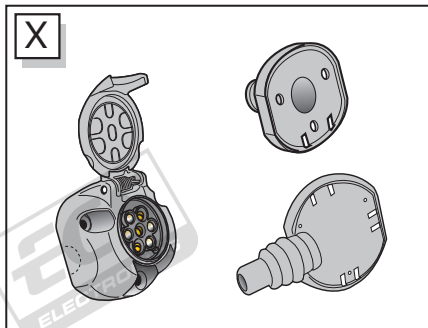

1x

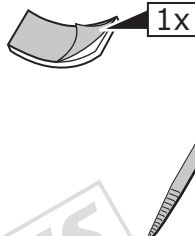

UN-243-YZ

Optional reverse lamp
pre-wire extension included



Pag. 15



3x

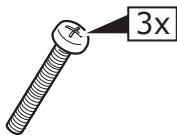

1x

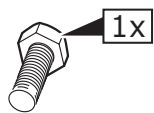

1x



3x

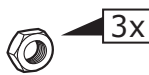

2x

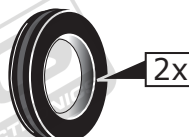

1x

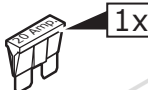

6x

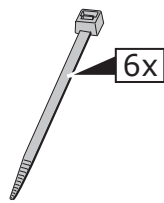

1

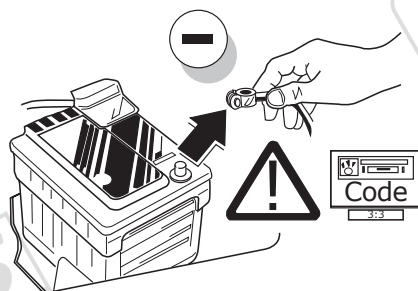

Galaxy / S-Max

2

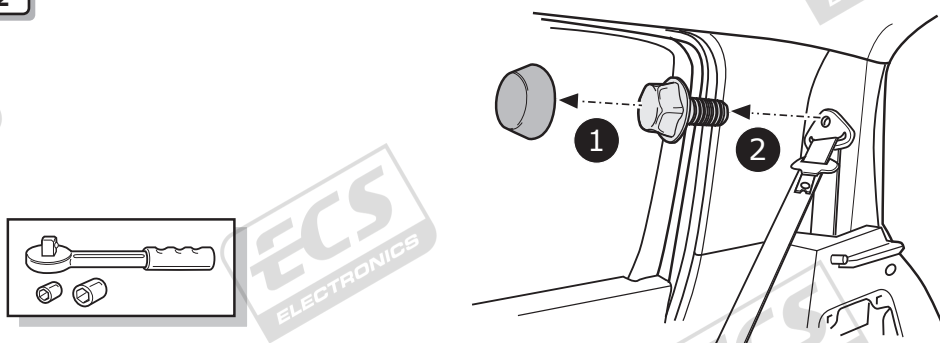

3

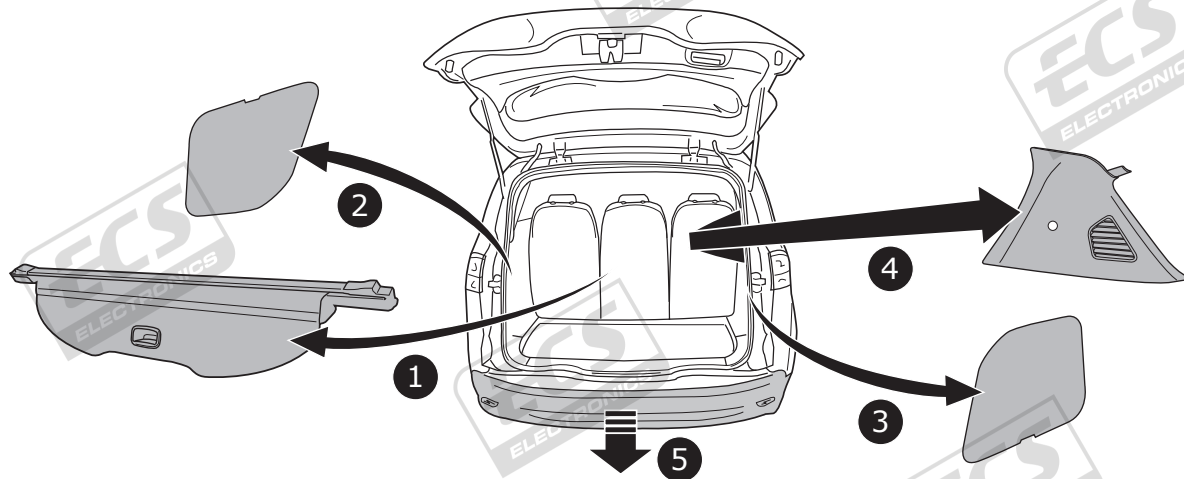

4

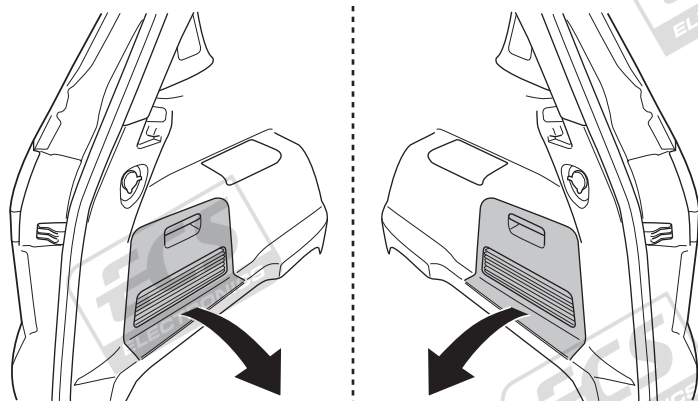

Galaxy / S-Max

5

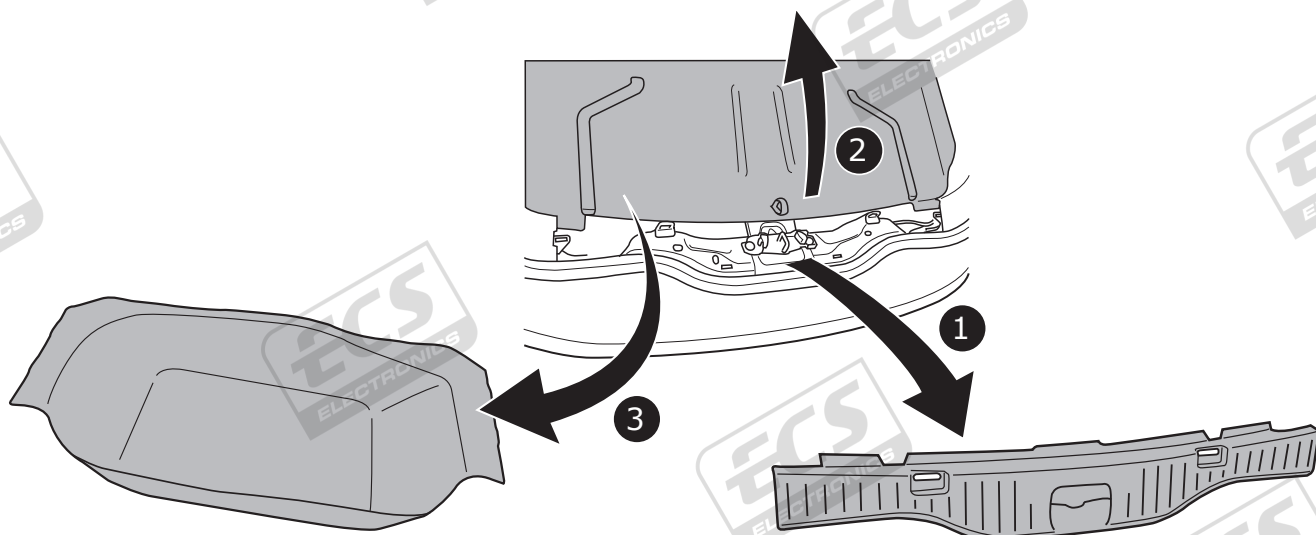

Mondeo Stationwagon

6

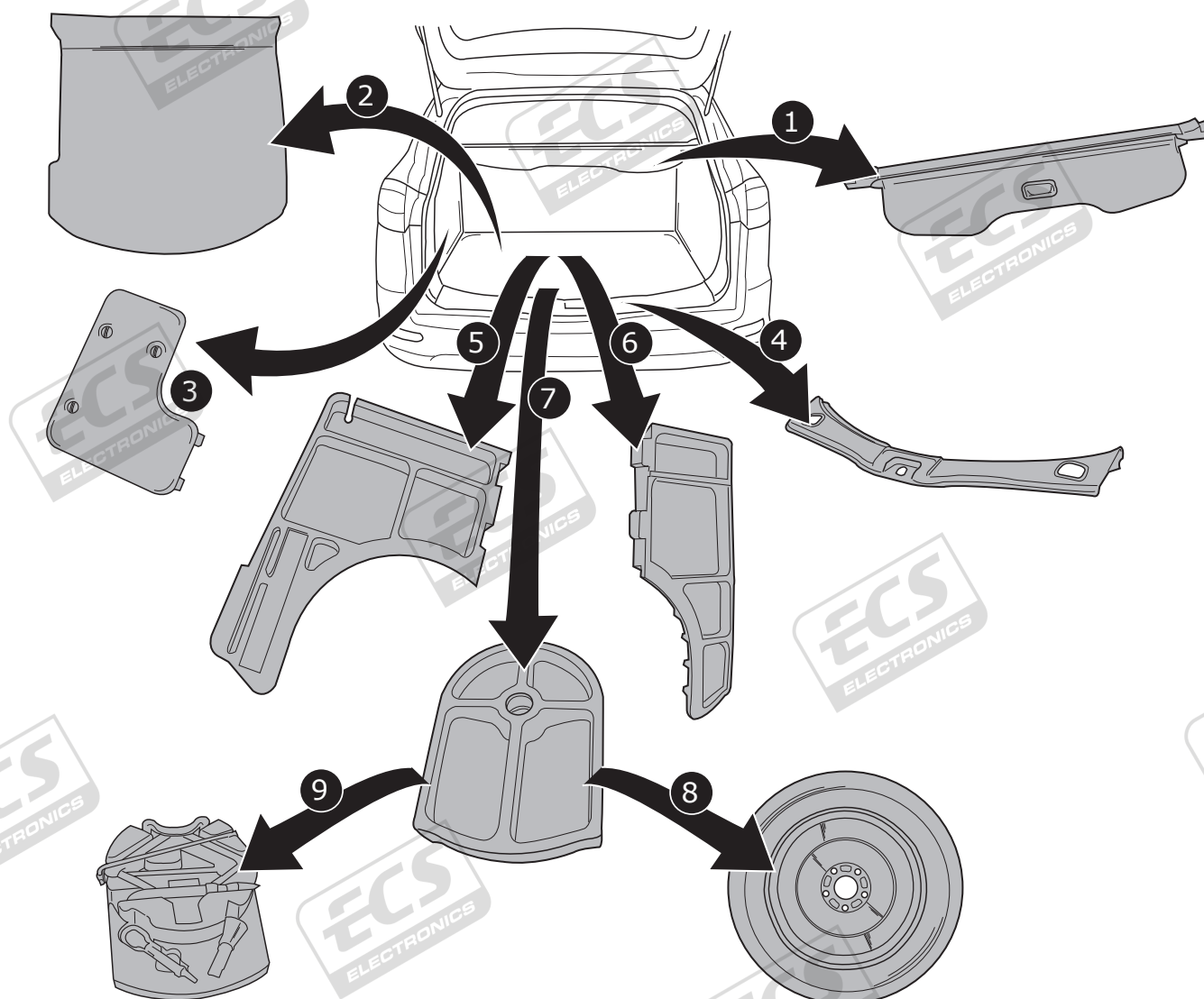

Mondeo Sedan, Hatchback

7

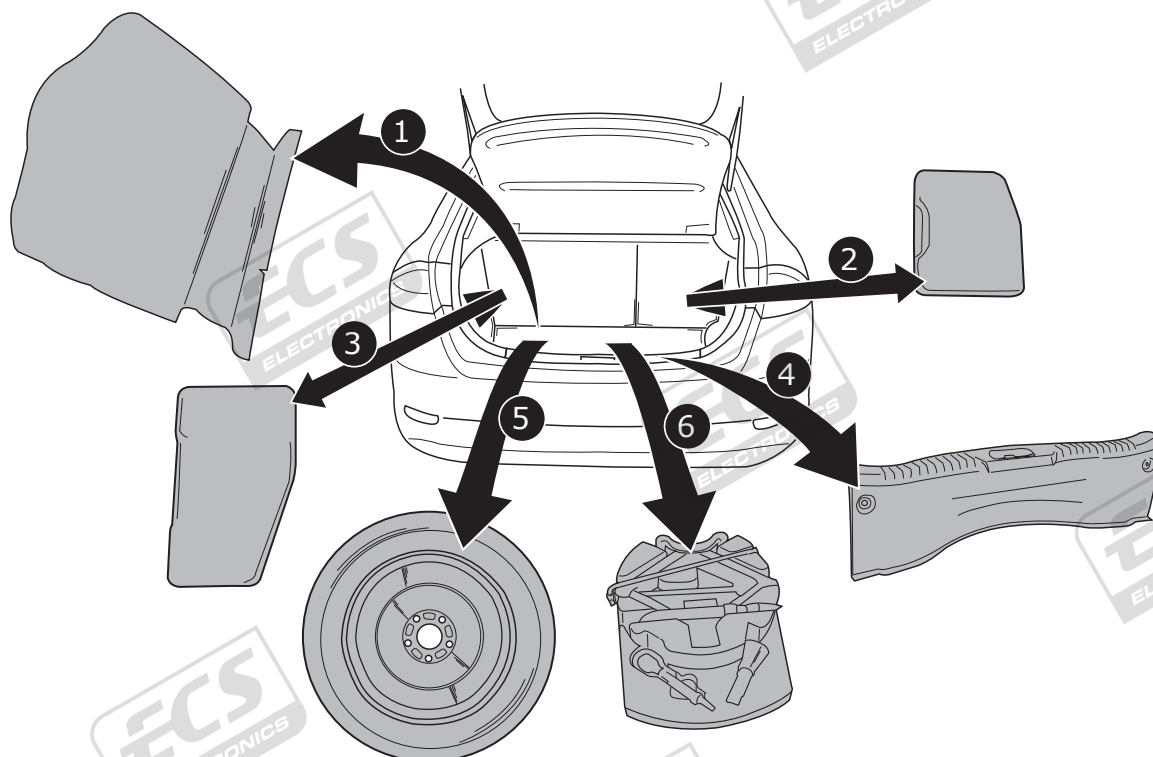

Galaxy / S-Max

ROUTING

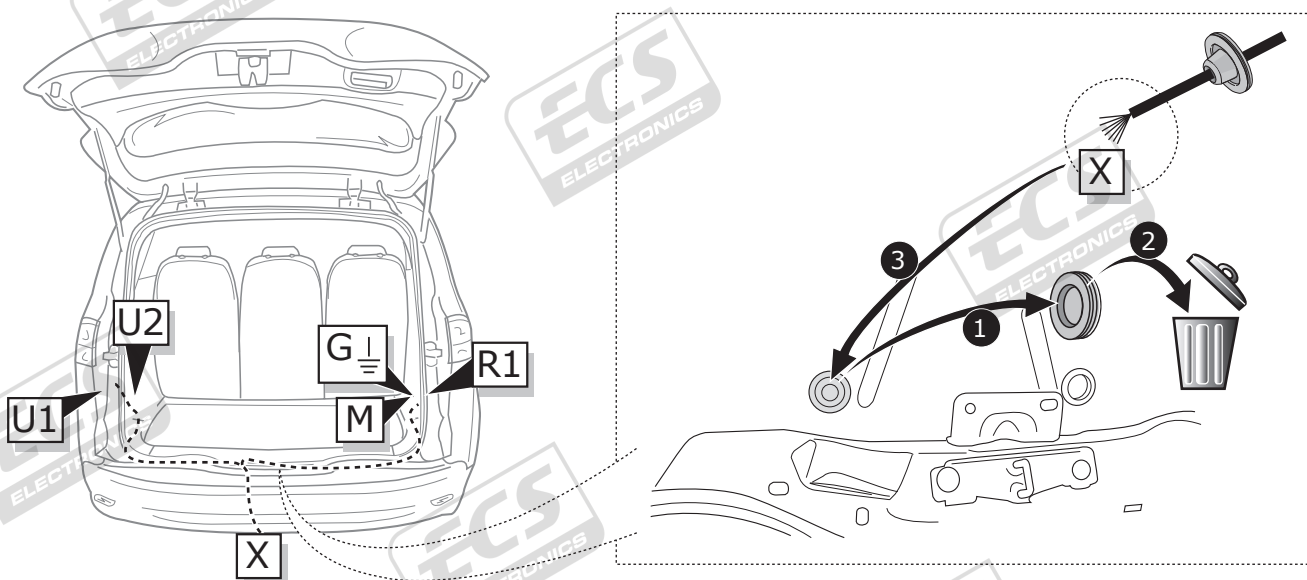

ROUTING

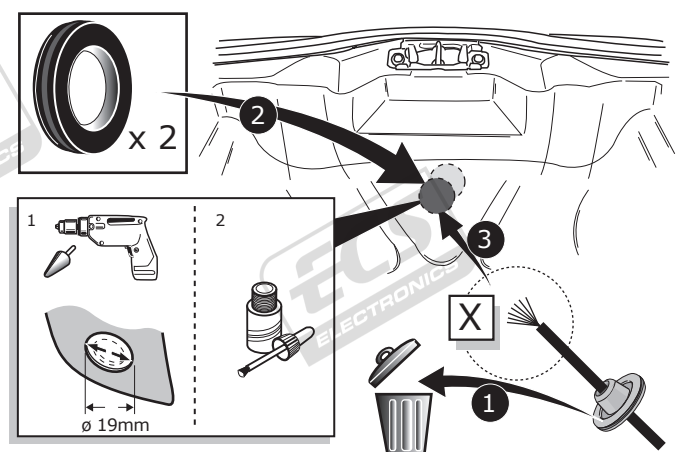
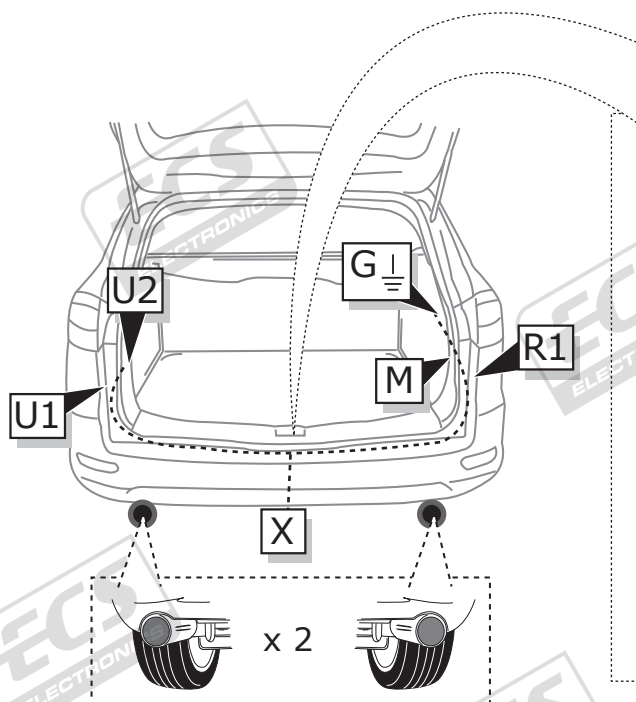
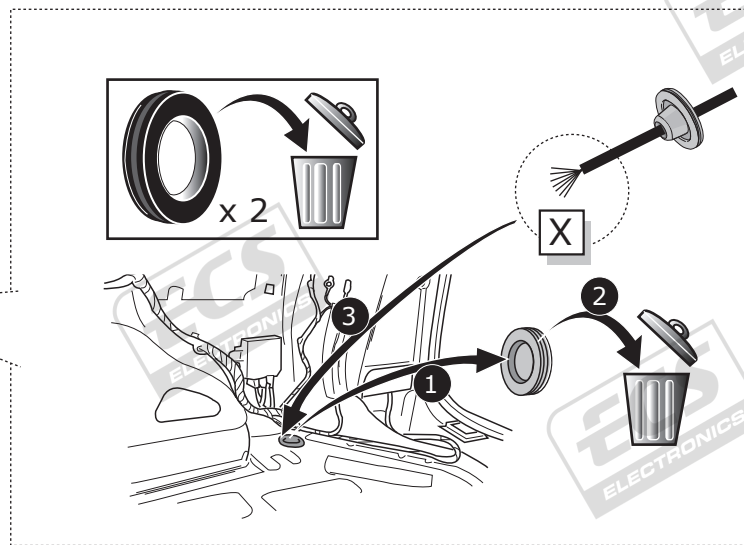
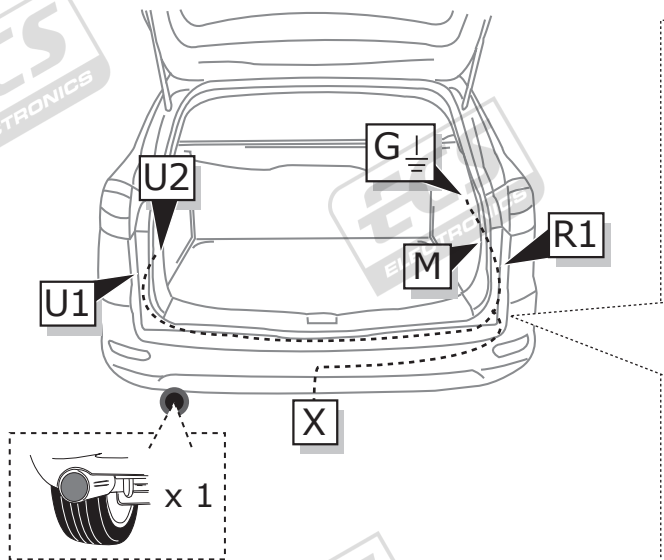

Mondeo Sedan, Hatchback

ROUTING

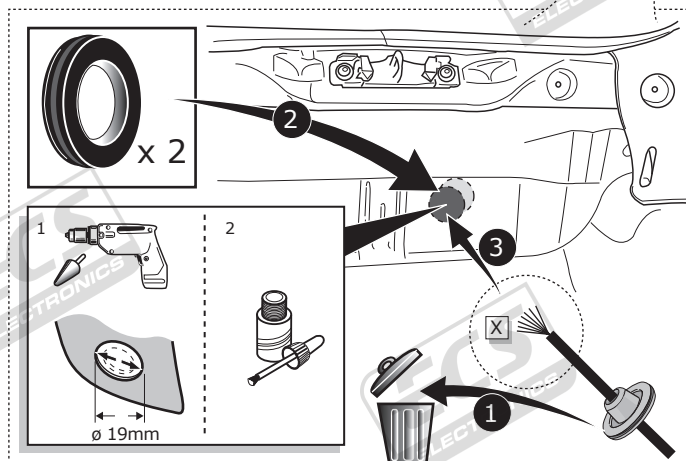
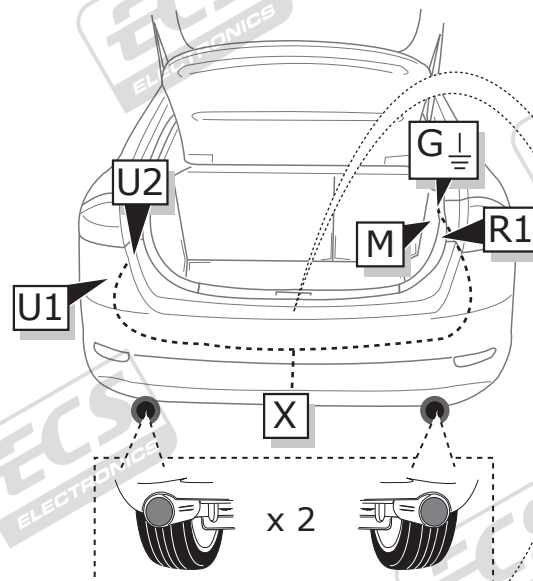
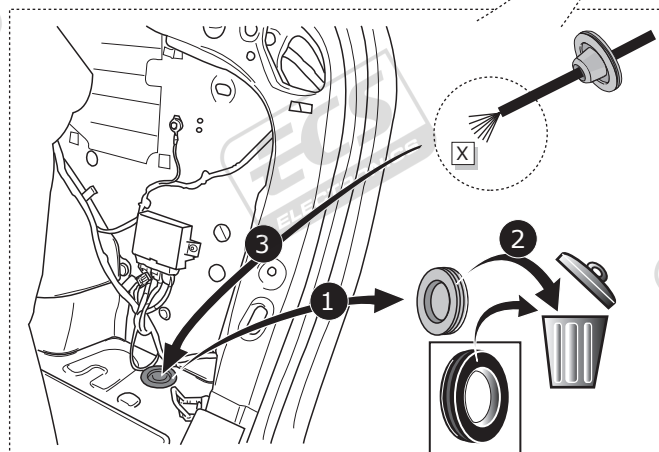
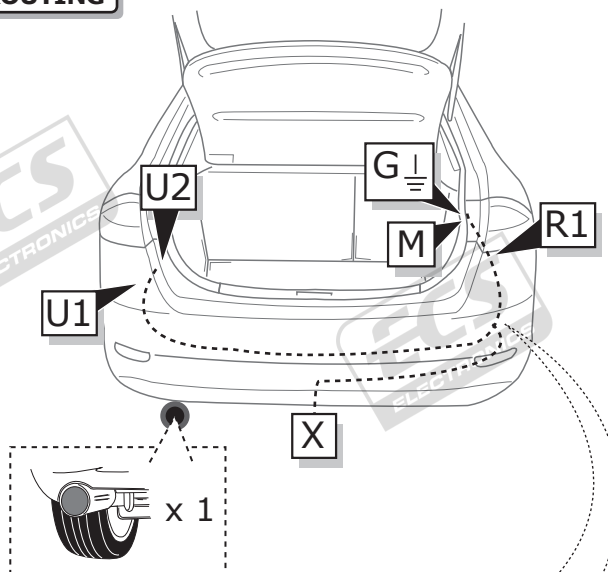

Mondeo Sedan, Hatchback, Stationwagon / Galaxy / S-Max

A

Option 1

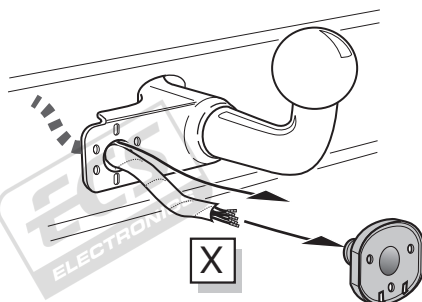

Option 2

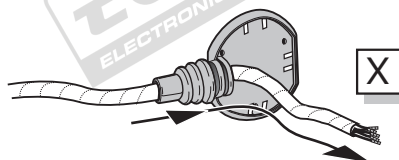

Option 3

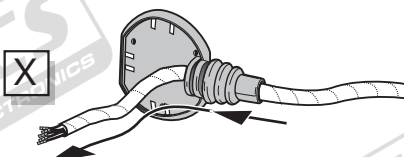

INFO

SOCKET CONNECTION



Pag. 14

B

Option 1

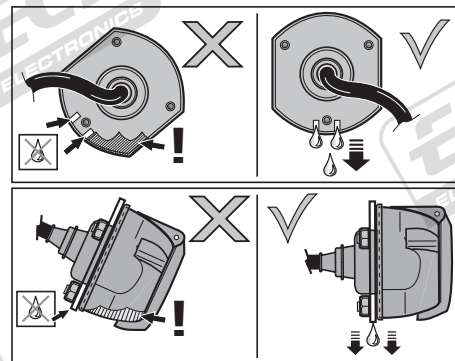
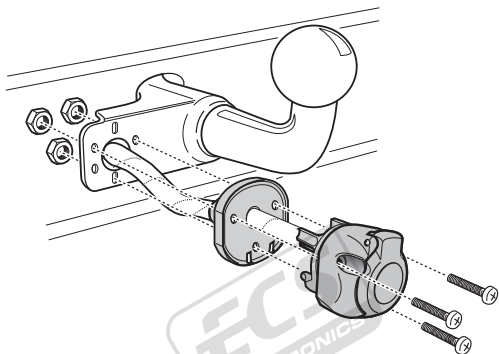

C

Option 2

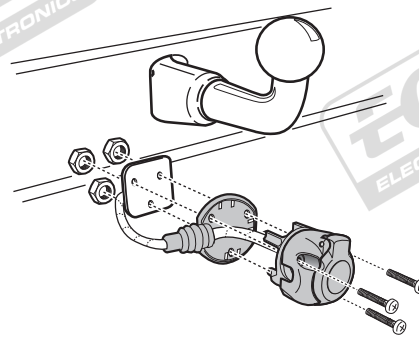
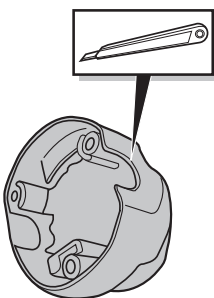
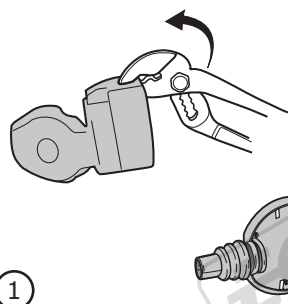

D

Option 3

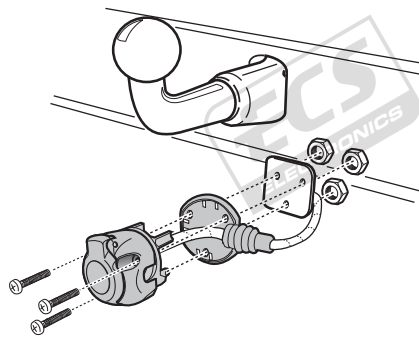
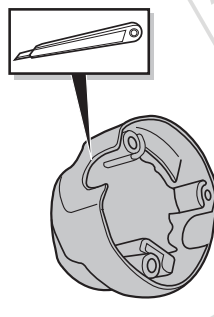
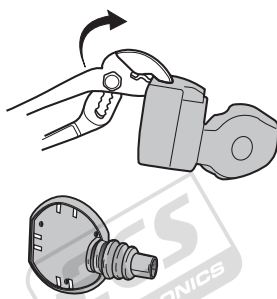

Galaxy / S-Max

8

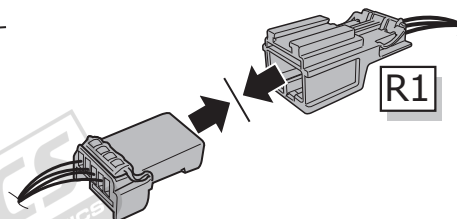
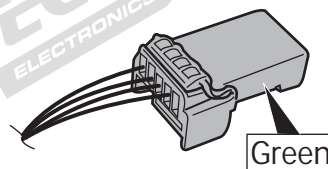
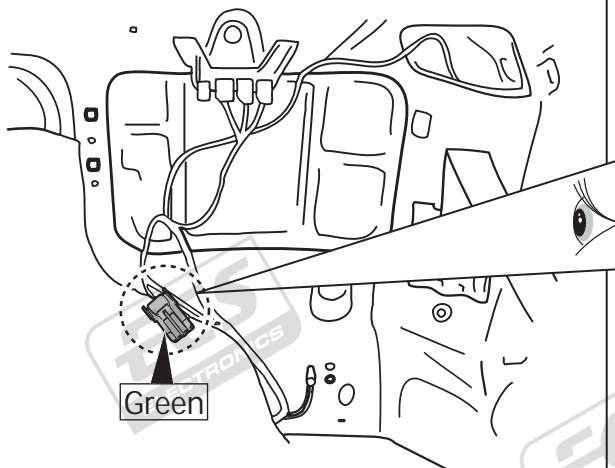
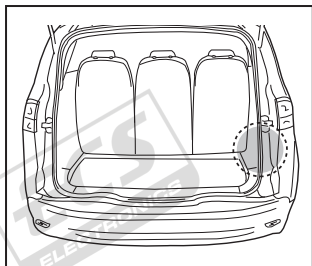

Mondeo Stationwagon

9

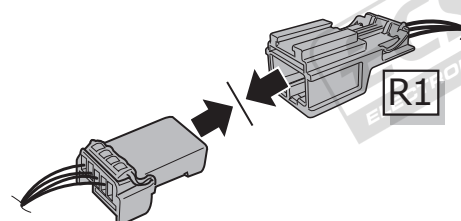
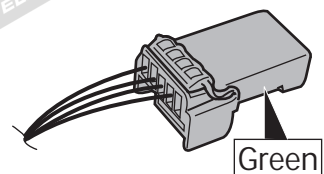
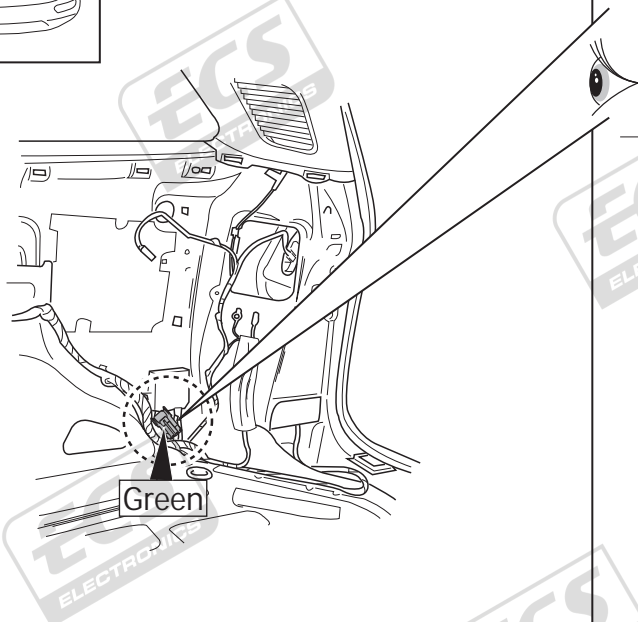
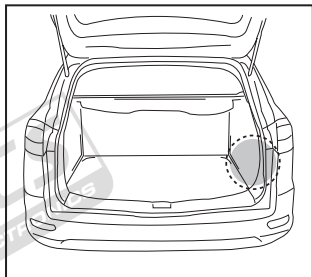

Mondeo Sedan, Hatchback

10

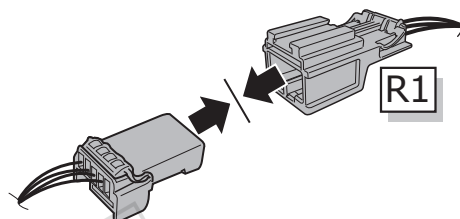
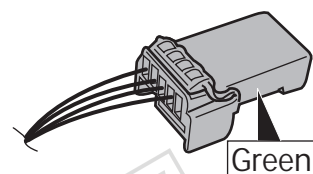
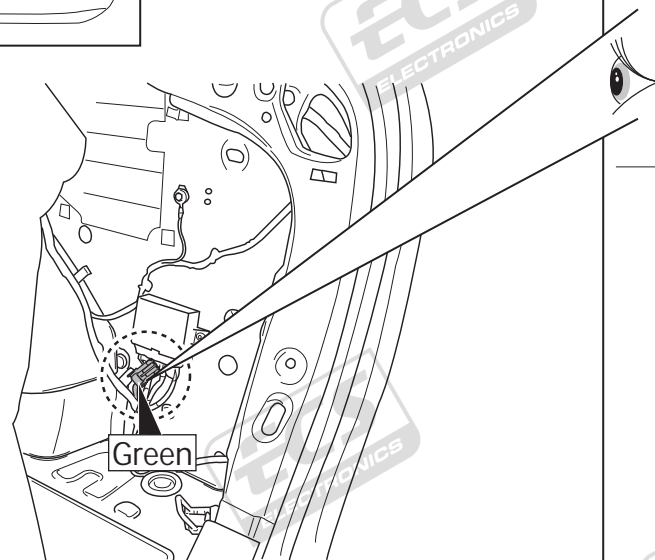
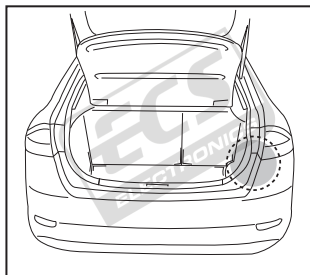

11

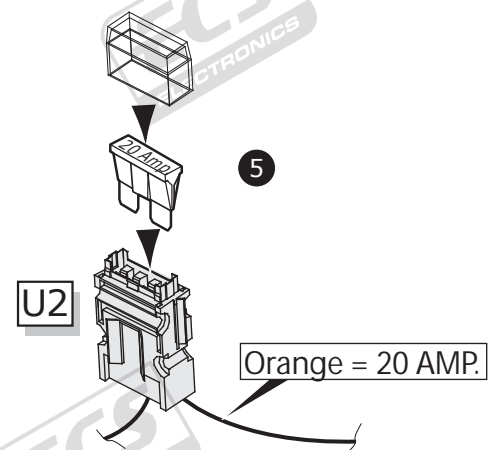
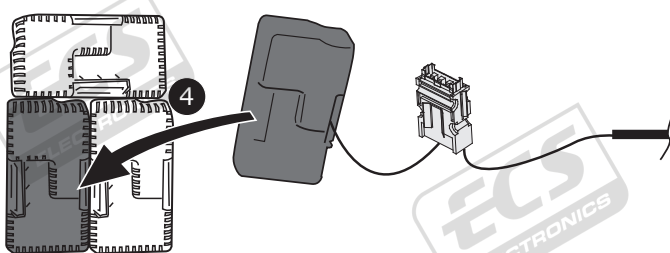
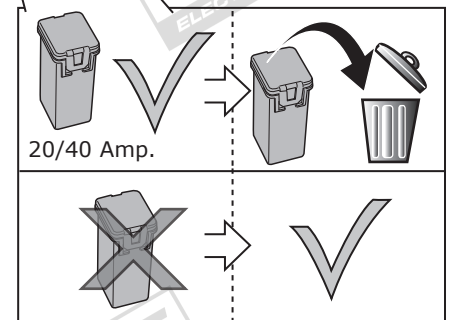
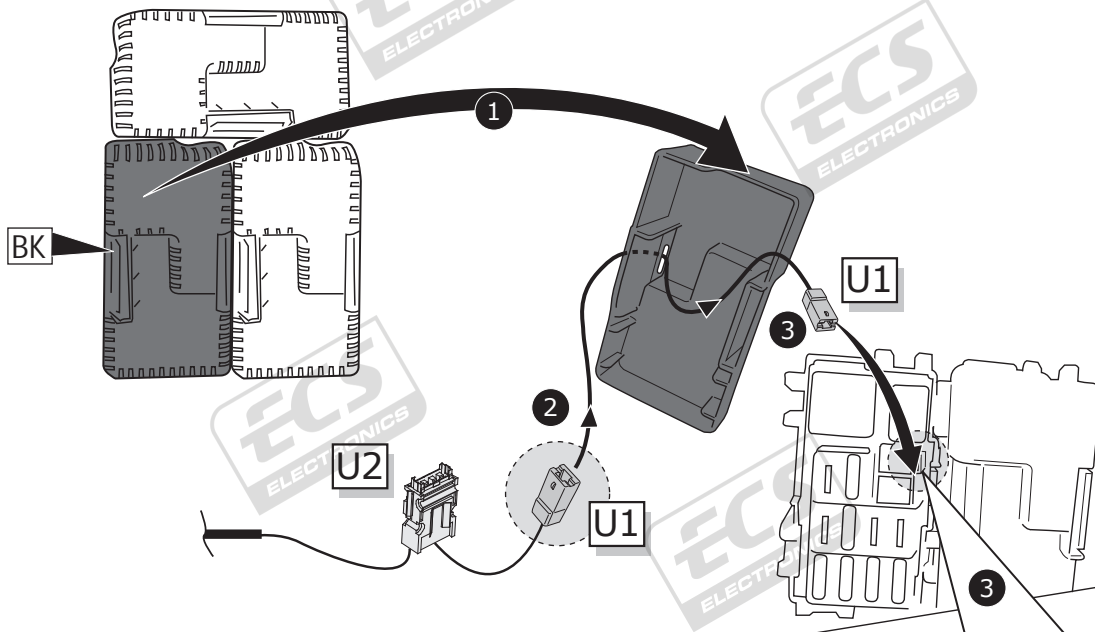
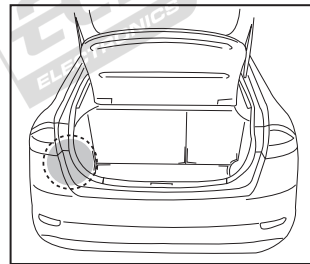
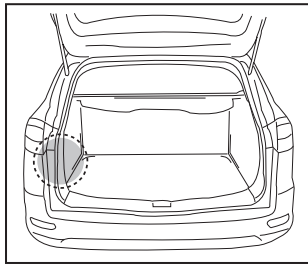
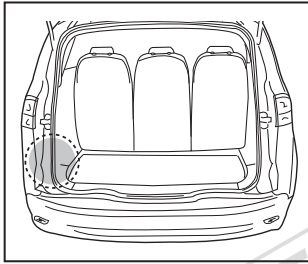

Mondeo Sedan, Hatchback, Stationwagon / Galaxy / S-Max

12

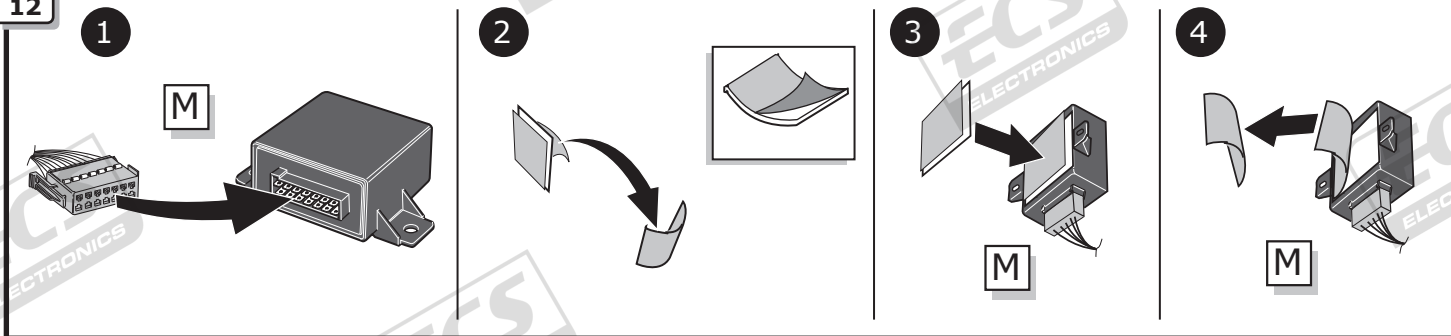

Galaxy / S-Max

13

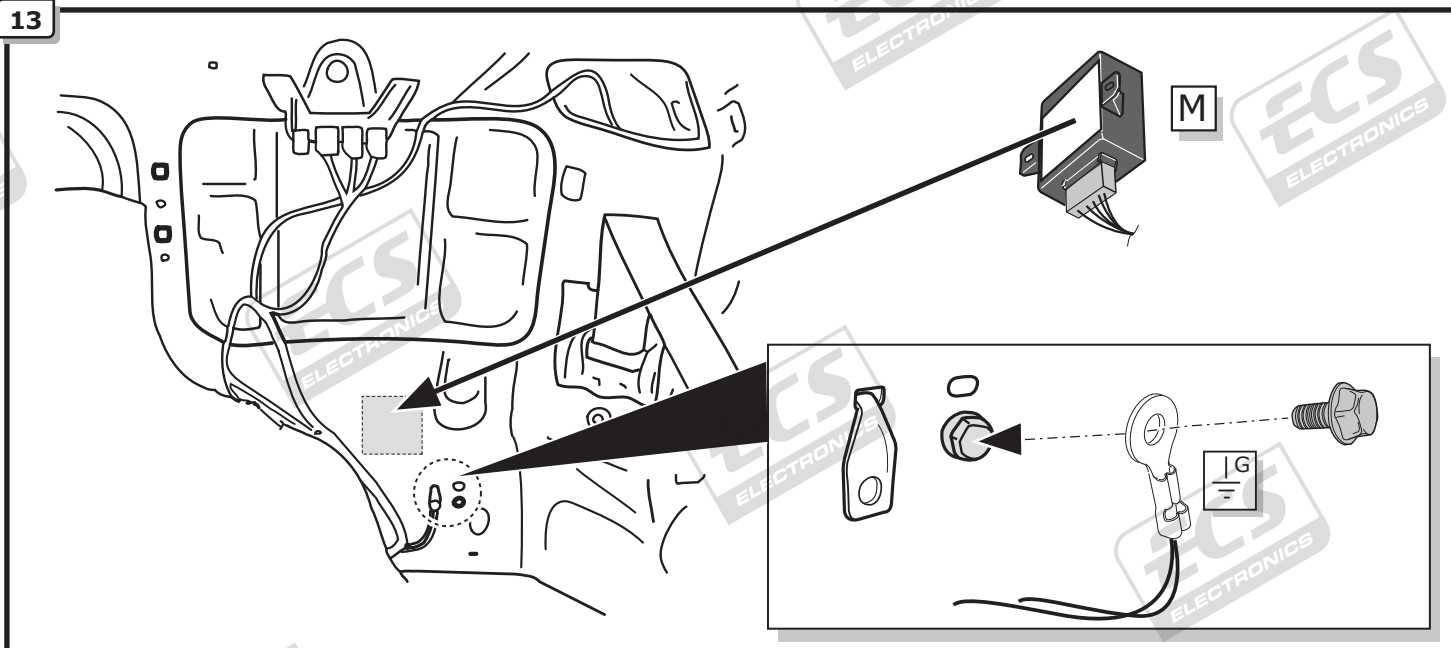

Mondeo Stationwagon

14

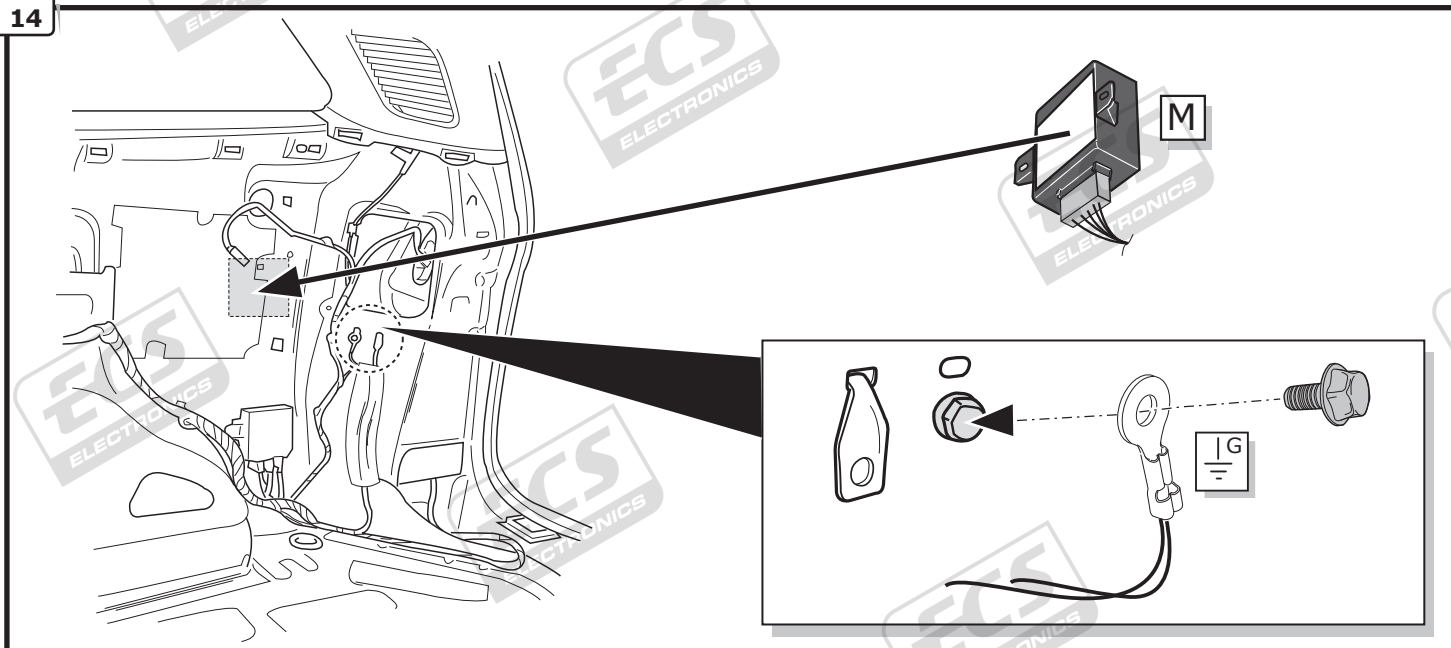

Mondeo Sedan, Hatchback

15

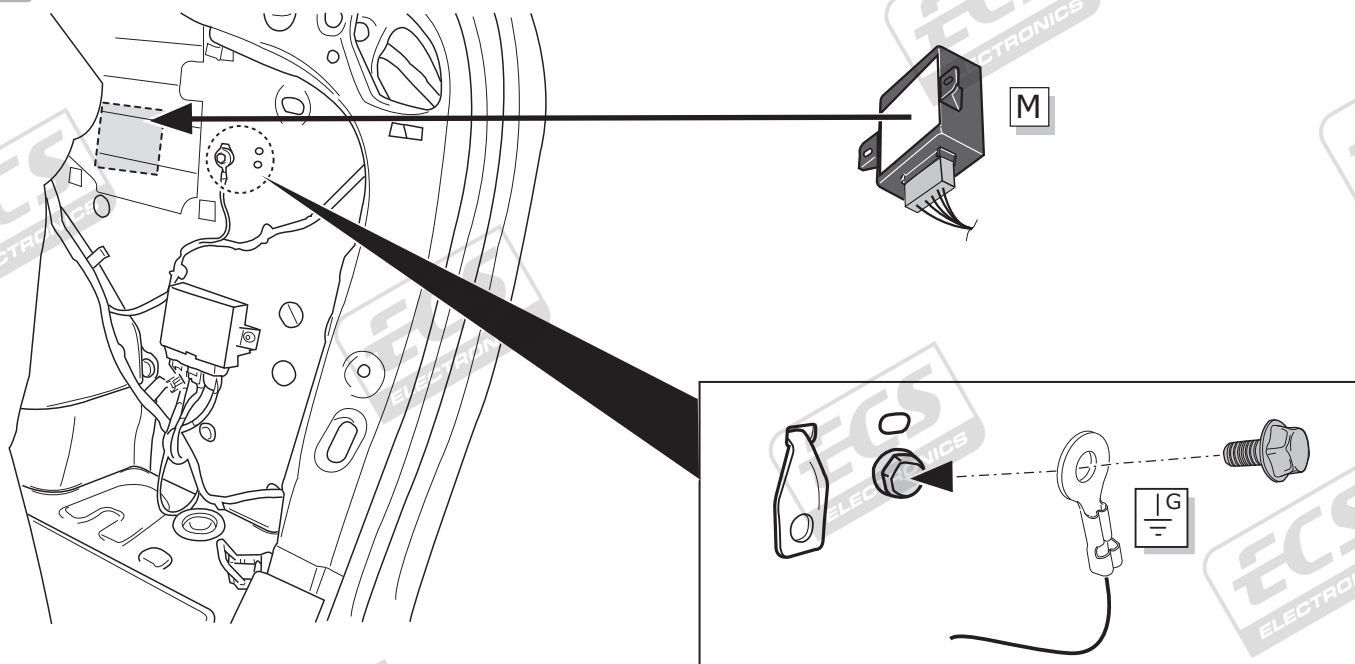

Mondeo Sedan, Hatchback, Stationwagon / Galaxy / S-Max

16

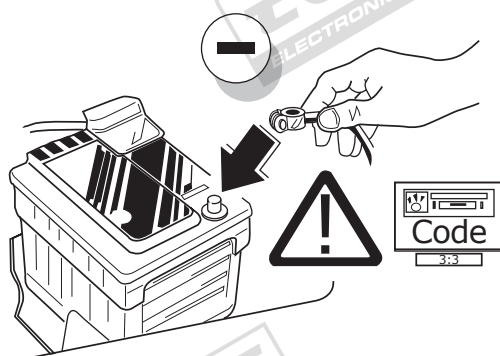

17

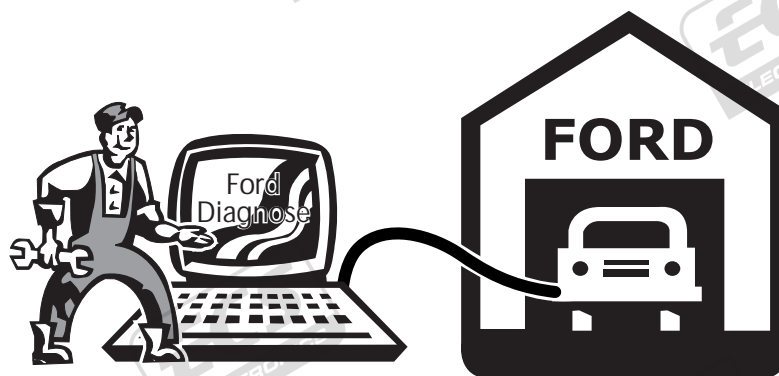

18

Option 1

Manual PDC

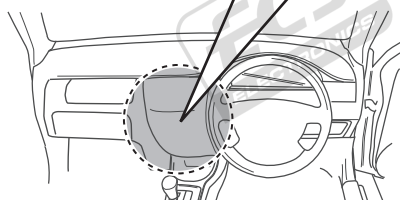
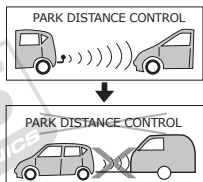

Option 2

Auto PDC

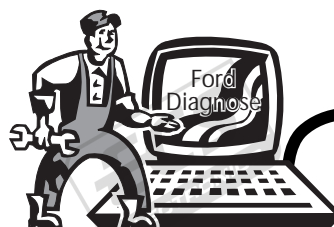
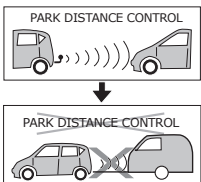

C2



19

! TEST ALL THE CIRCUITS WITH A TEST DEVICE WITH THE CORRECT POWER LOAD FOR EACH FUNCTION. A TEST DEVICE WITH LED'S CANNOT BE USED FOR THIS PURPOSE.

INFO

REINSTALL TRIM.



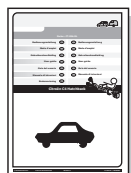
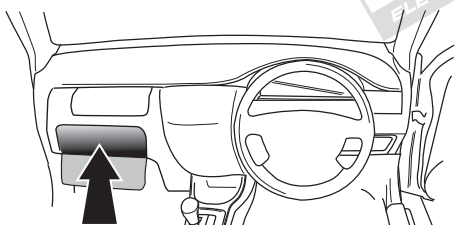



20



User guide

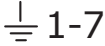

SOCKET CONNECTION

DIN/ISO 1724			 1-7				
	1/L	2	3/31	4/R	5/58-R	6/54	7/58-L
Pmax	21W	21W		21W	42W	3x21W	42W
Colour	Yellow	Blue	White	Green	Brown	Red	Black

UN-243-YZ Reverse lamp pre-wire extension

⚠ MAX = 21W

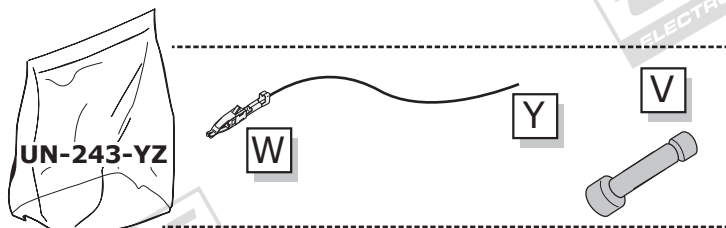

A

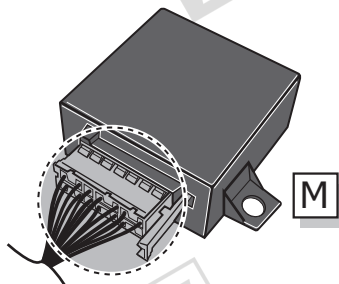

1

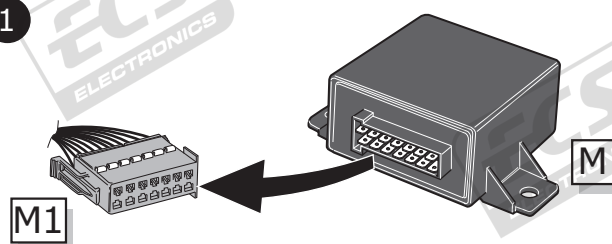

2

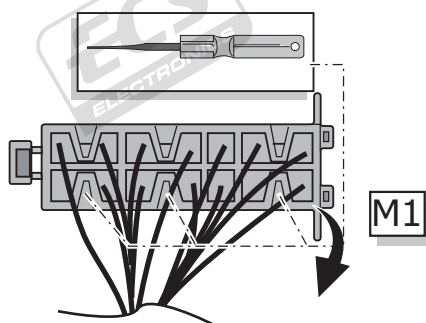

3

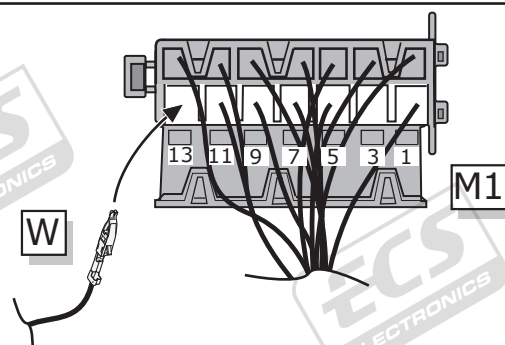

4

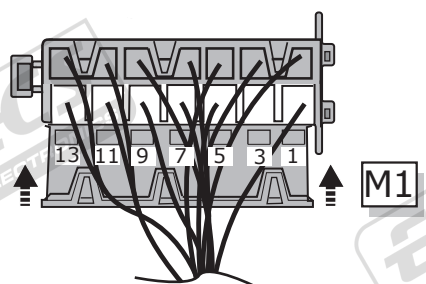

5

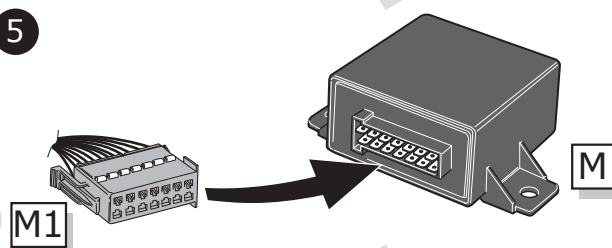

B

⚠ MAX = 21W

