

**Mercedes Benz V Class 04/2014-
Mercedes Benz Vito 11/2014-**

Partnr.: MB-081-B1U

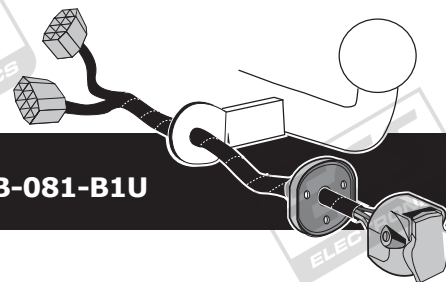

- Fitting instructions electric wiring kit tow bar with 12-N socket up to DIN/ISO Norm 1724.
- We would expressly point out that assembly not carried out properly by a competent installer will result in cancellation of any right to damage compensation, in particular those arising by virtue of the product liability act.
- Contents of these kits and their fitting manuals are subject to alteration without notice, please ensure that these instructions are read and fully understood before commencing installation.
- Do not overload circuits; the maximum loads per connection are detailed in this manual.
- Attention! Before Installation, please read this manual carefully and inform your customer to consult the vehicle owners manual to check for any vehicle modifications required before towing.
- In the event of functional problems, troubleshooting must be limited to about 0.5 hours, contact the technical support:
t.skinner@ecs-electronics.com / 07440 202 052.



Part list

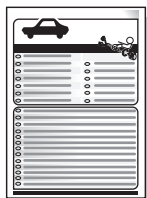
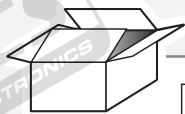

U3



U2

M

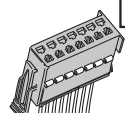

G

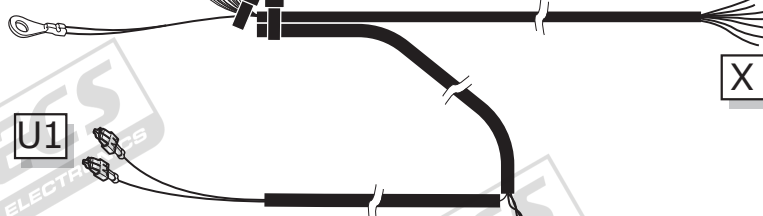

U1

X

T

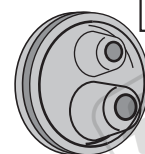

1x

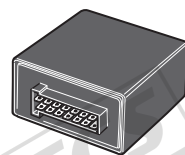

M

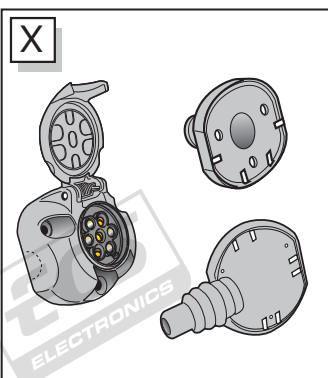

X

A

B



15x



4x

UN-243-YZ

Optional reverse lamp pre-wire extension included



Pag. 14

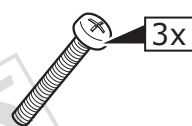

3x

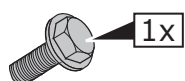

1x

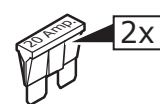

2x



2x



3x



1x

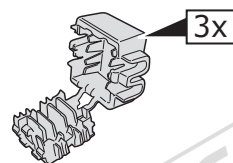

3x

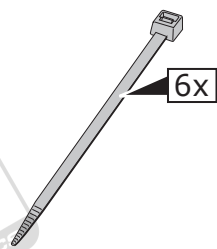

6x

ROUTING

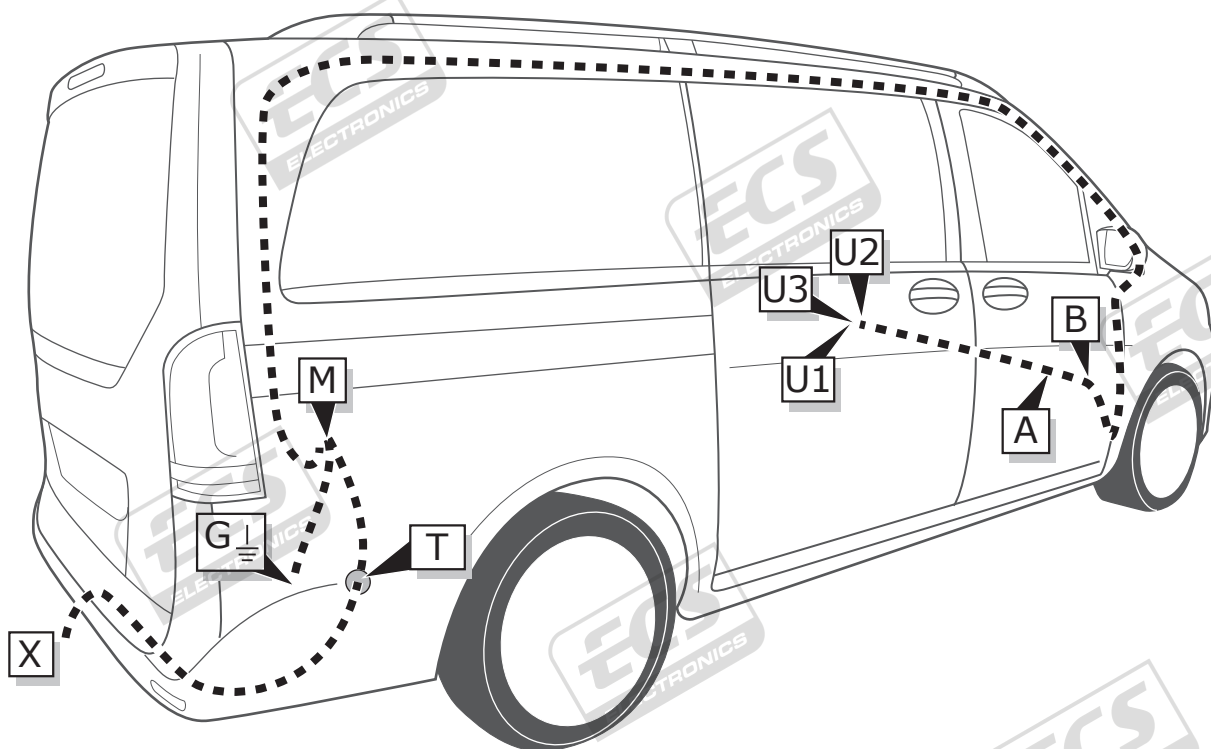

1

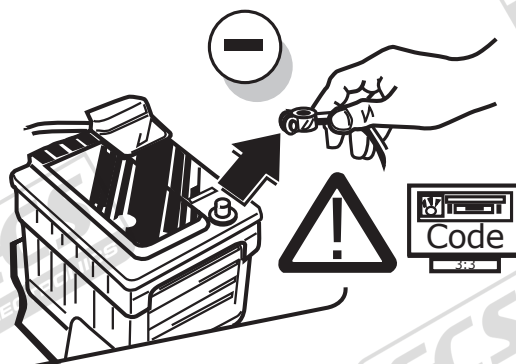

2

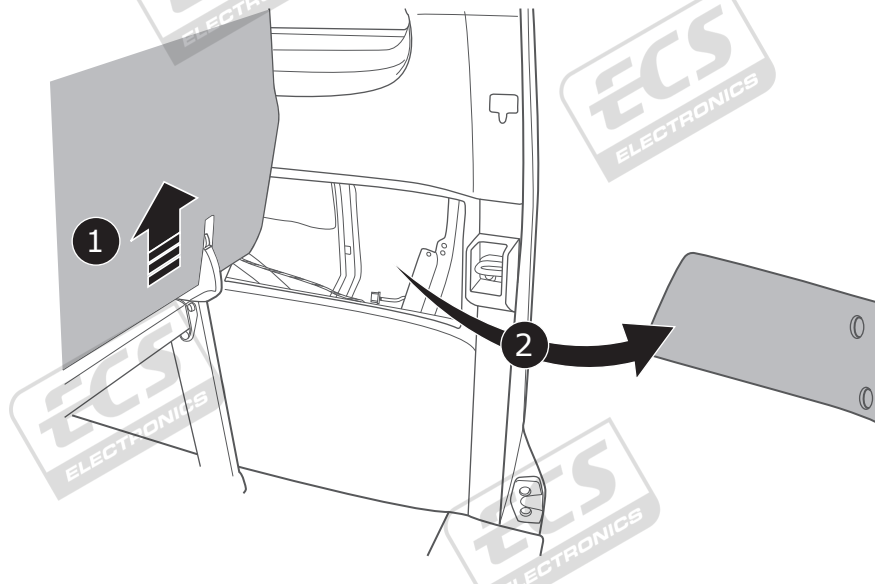
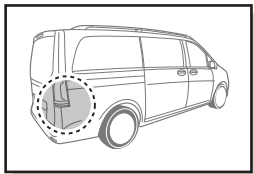

3

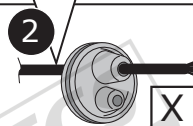
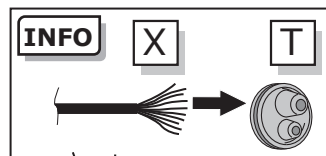
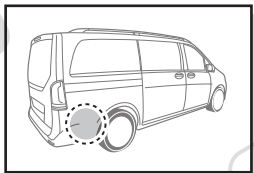

SEAL WITH SILICONE.

A

Option 1

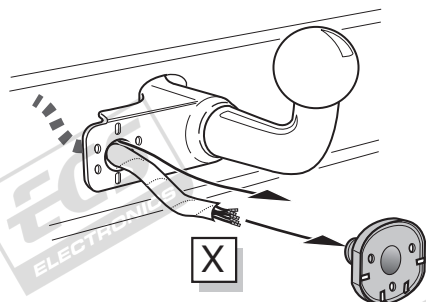

Option 2

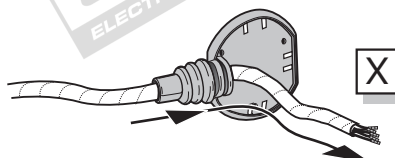

Option 3

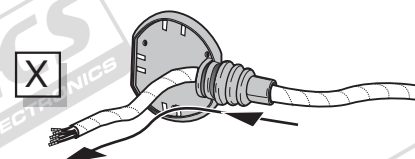

INFO

SOCKET CONNECTION



Pag. 13

B

Option 1

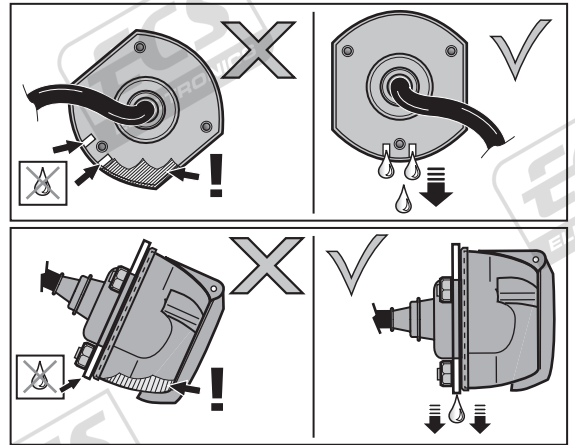
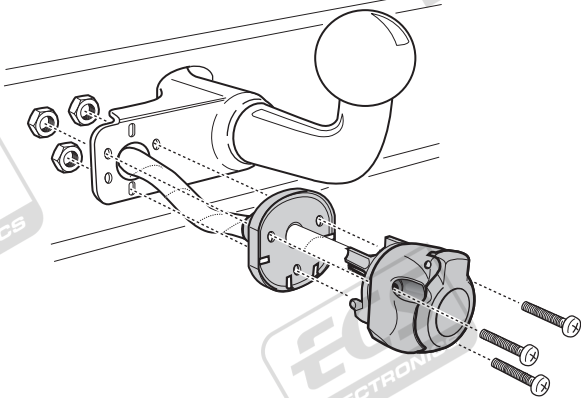

C

Option 2

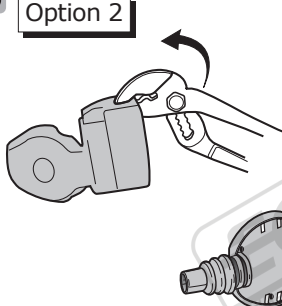

1

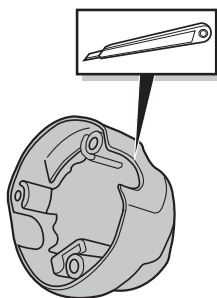

2

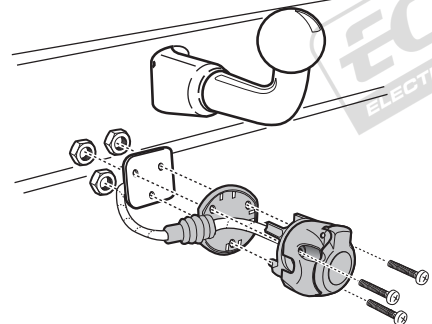

3

D

Option 3

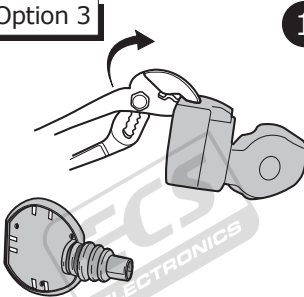

1

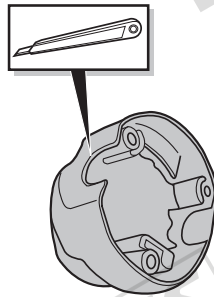

2

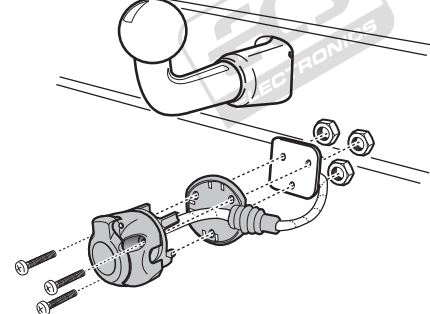

3

4

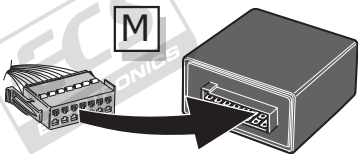

1

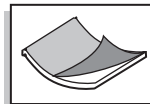

2

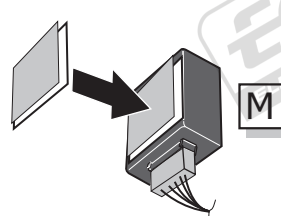

3

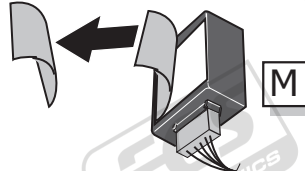

4

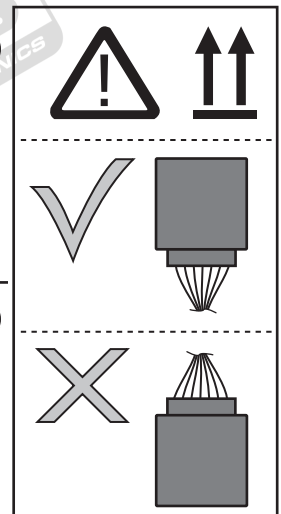

5

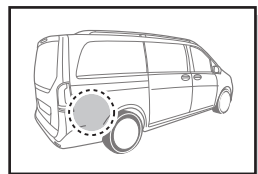

M

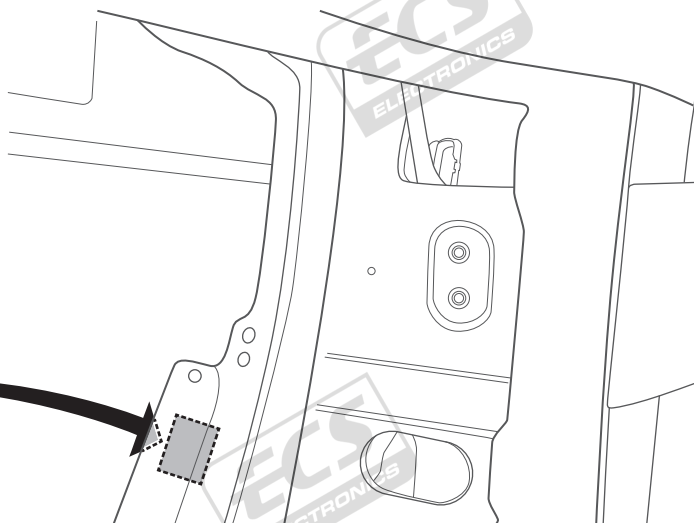
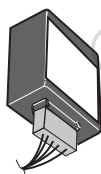

6

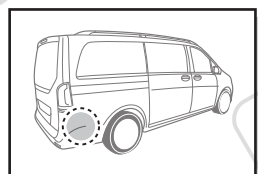

Option 1

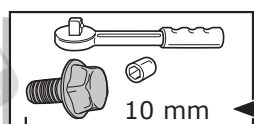

1

2

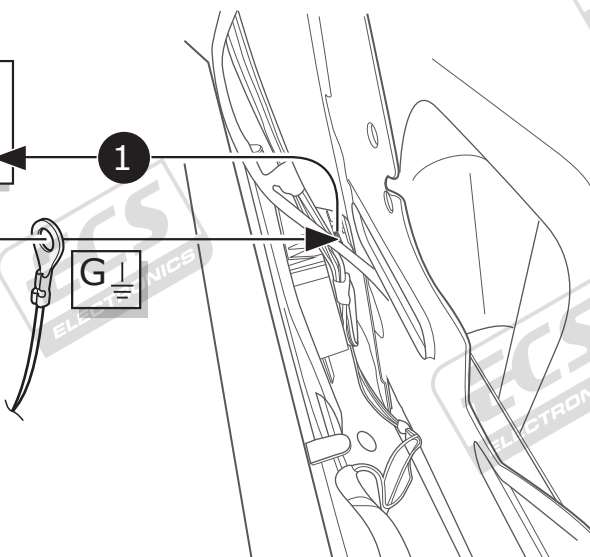

Option 2

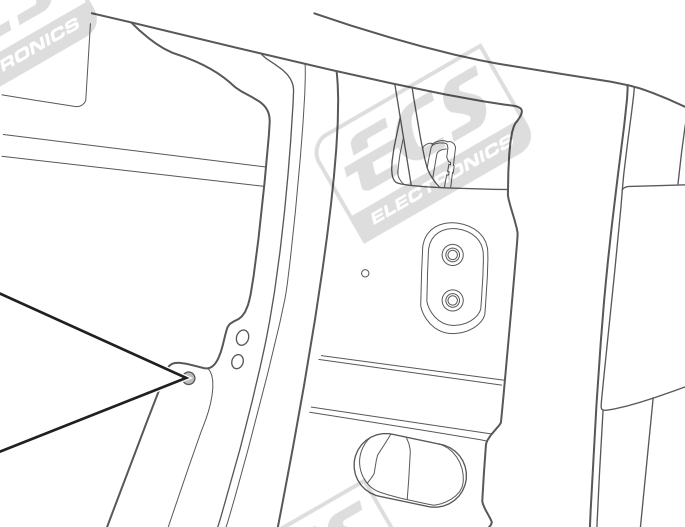
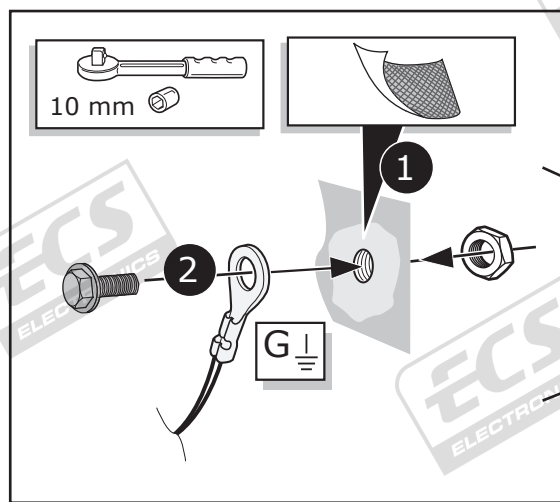

7

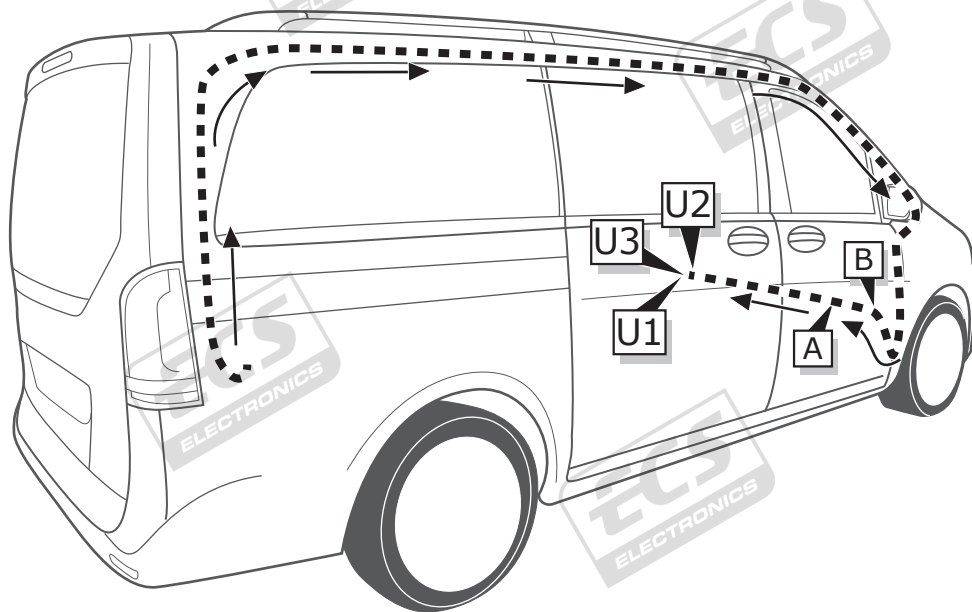

8

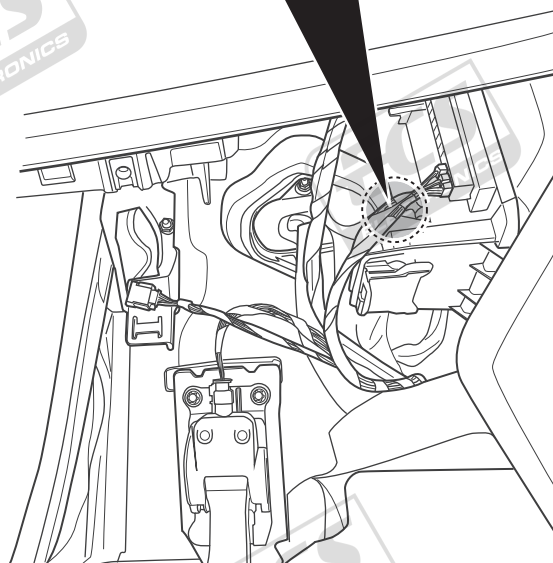
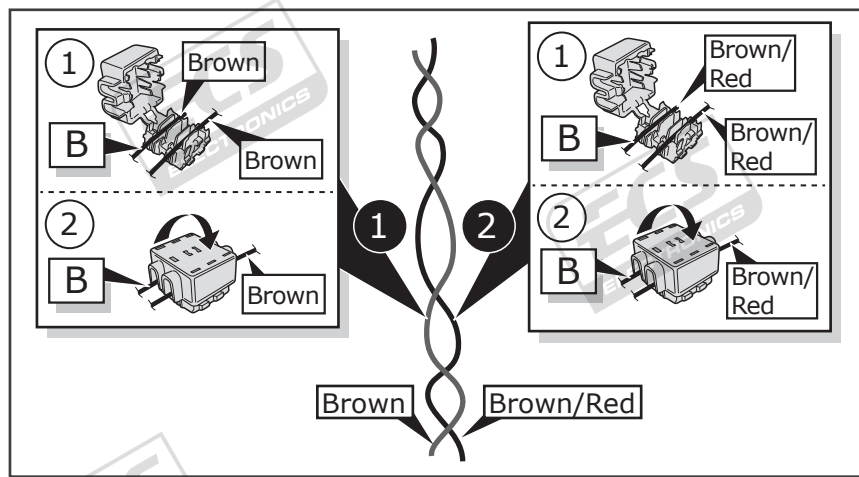
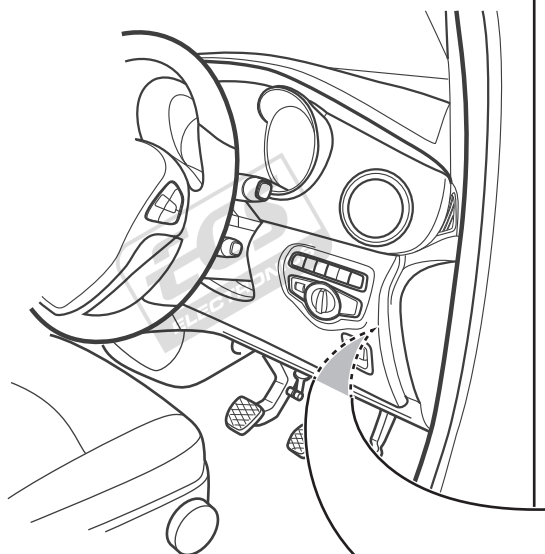

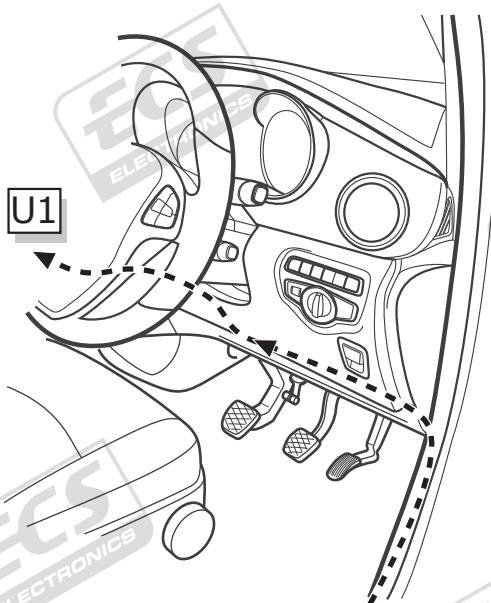
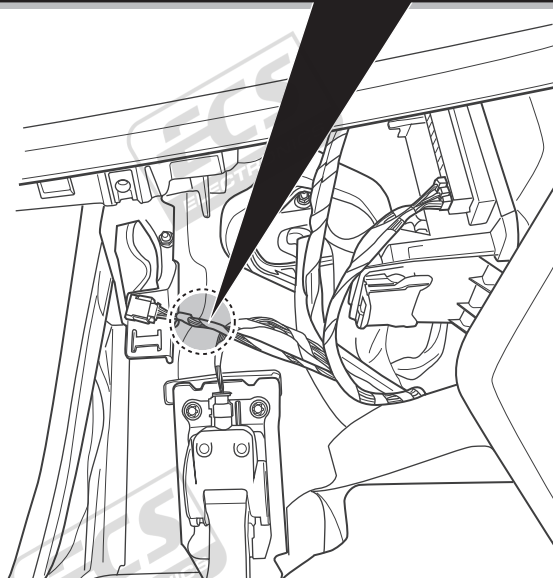
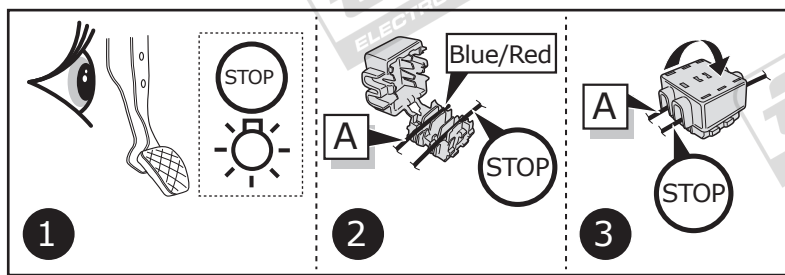

11

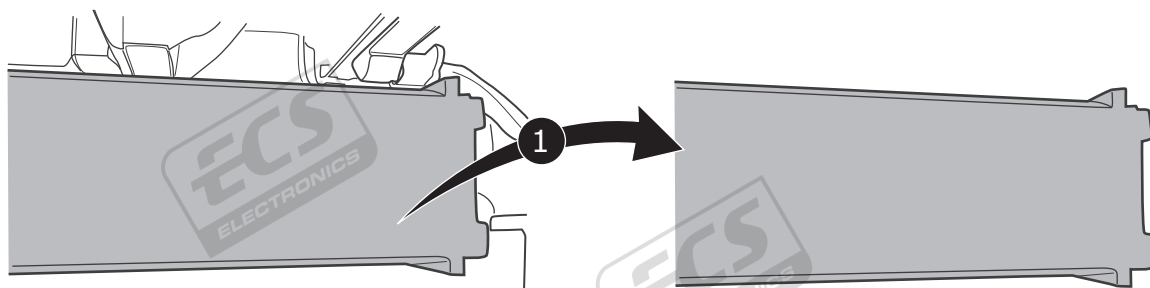
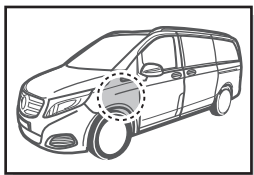

2

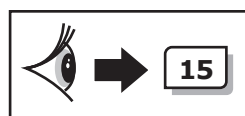
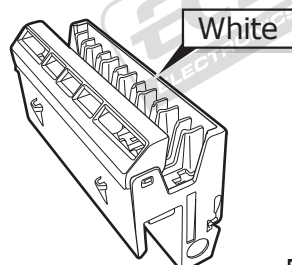
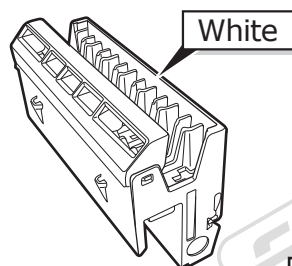
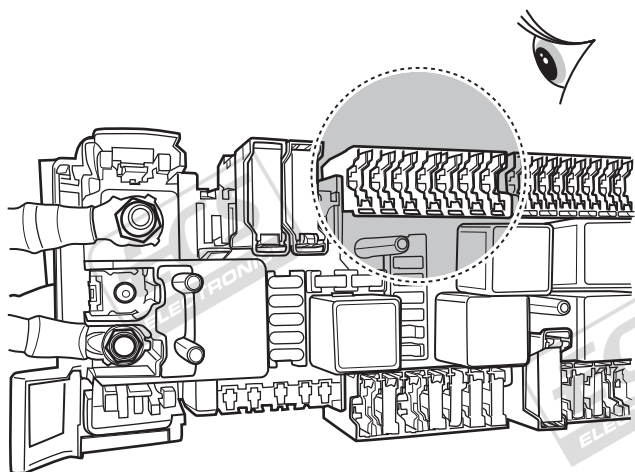

12

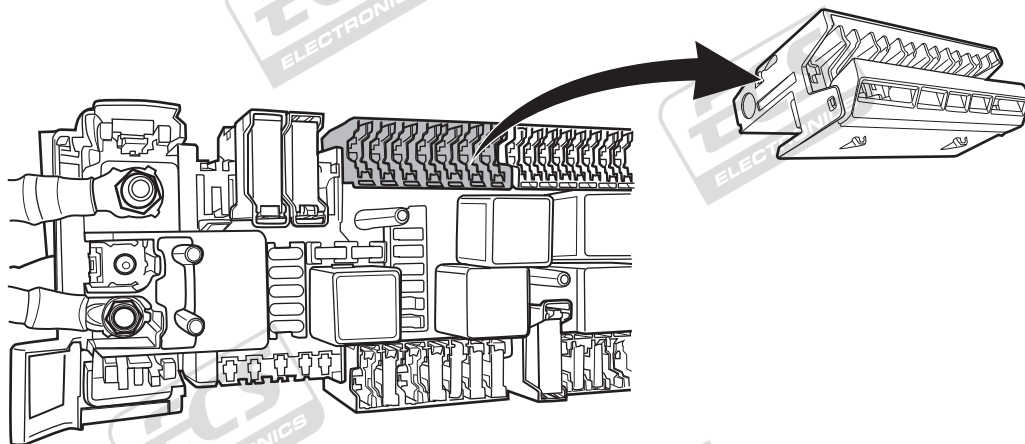

13

1

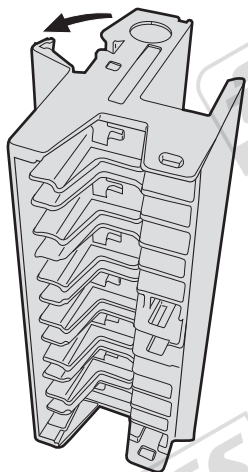

2

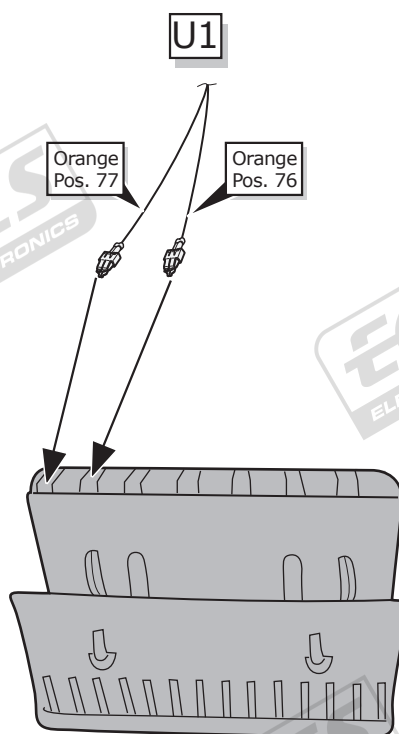

3

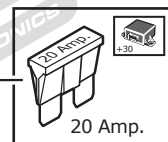
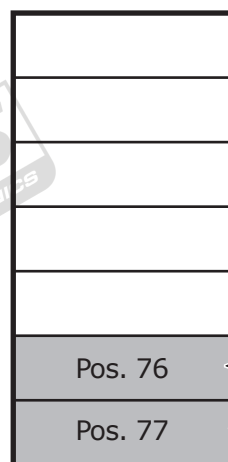

20 Amp.

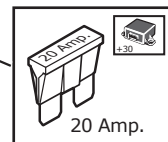

20 Amp.

14

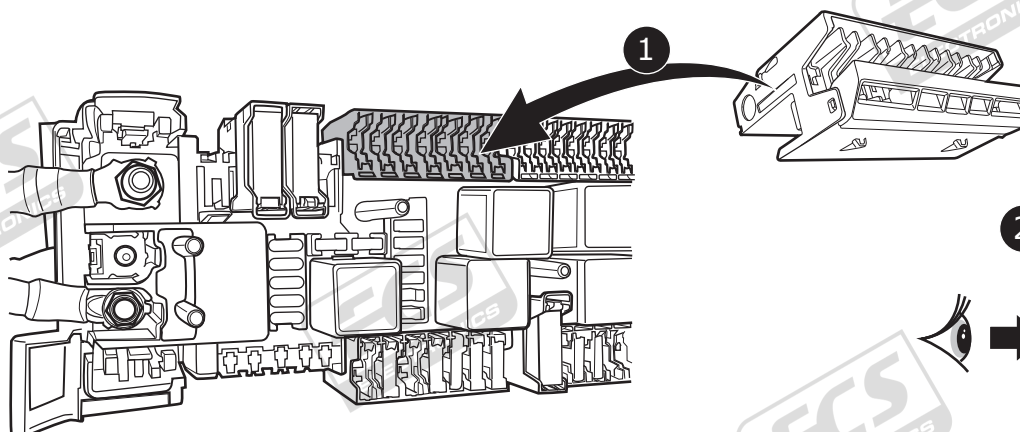

2

Pag. 11

INFO

15

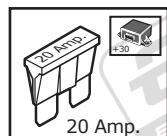
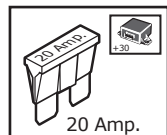
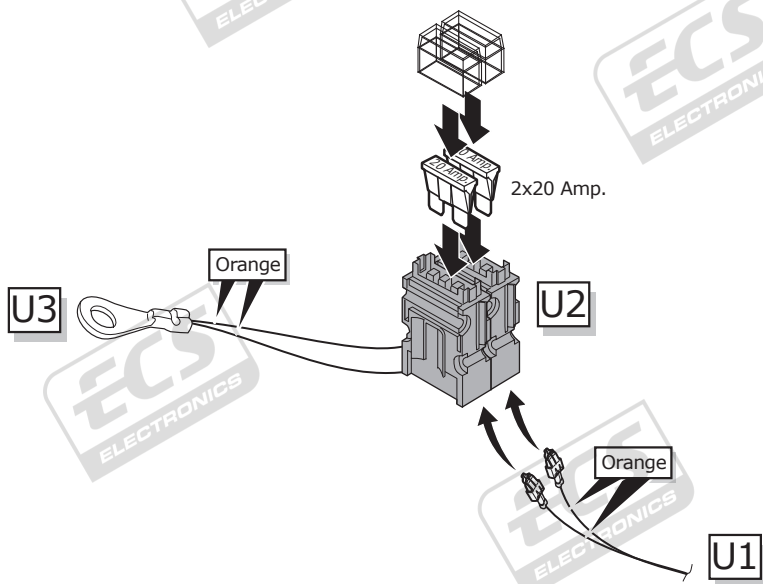

16

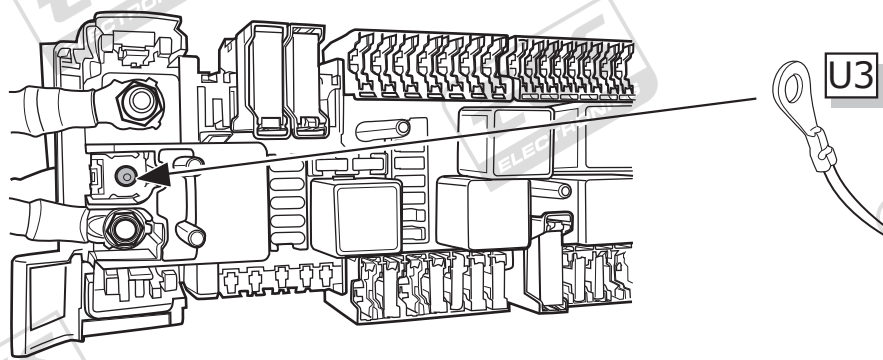

INFO

Manual PDC

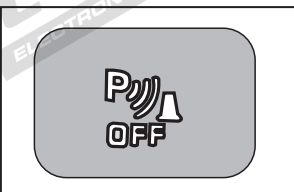
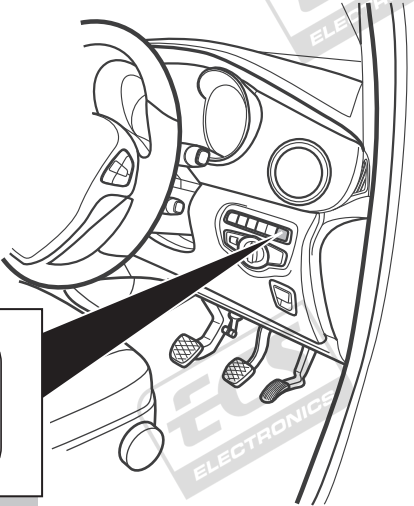
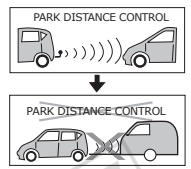

+ C2

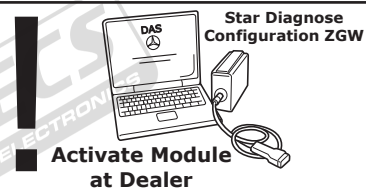

Activate Module at Dealer



17

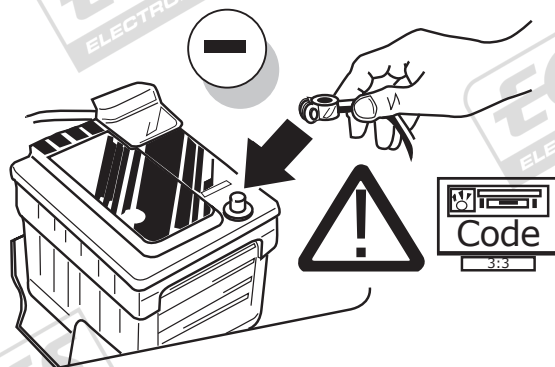

18

TEST ALL THE CIRCUITS WITH A TEST DEVICE WITH THE CORRECT POWER LOAD FOR EACH FUNCTION. A TEST DEVICE WITH LED'S CANNOT BE USED FOR THIS PURPOSE.

INFO

REINSTALL TRIM.



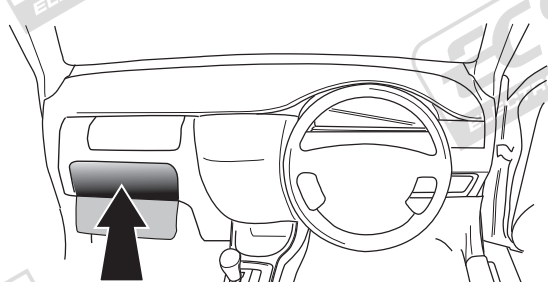



19



User guide

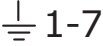

SOCKET CONNECTION

DIN/ISO 1724							
	1/L	2	3/31	4/R	5/58-R	6/54	7/58-L
Pmax	21W	2x21W		21W	52W	3x21W	52W
Colour	Yellow	Blue	White	Green	Brown	Red	Black

UN-243-YZ Reverse lamp pre-wire extension

⚠ MAX = 21W

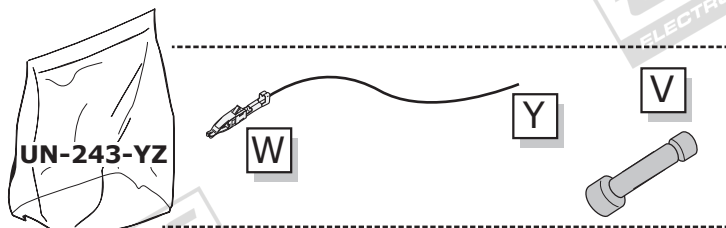

A

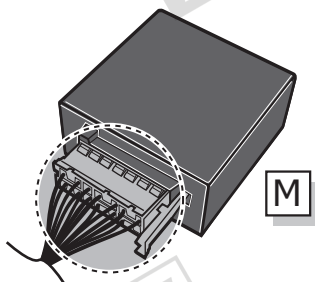

1

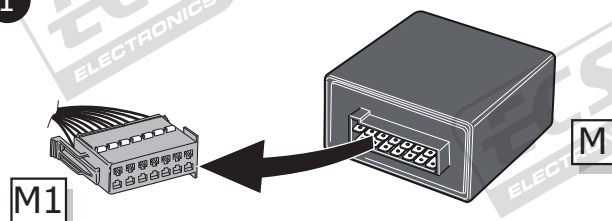

2

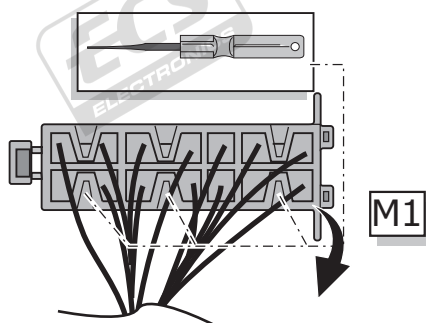

3

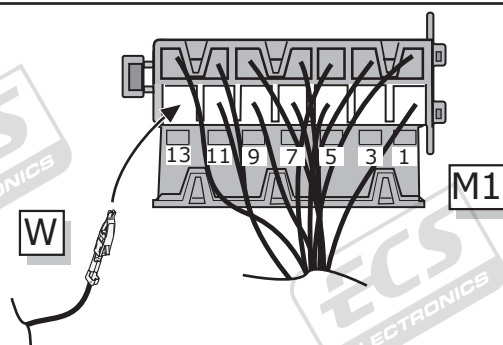

4

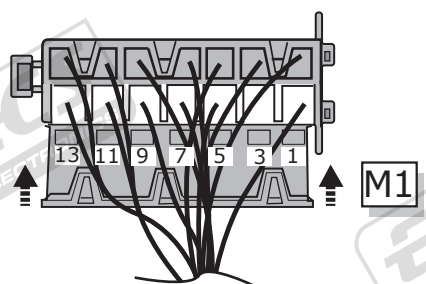

5

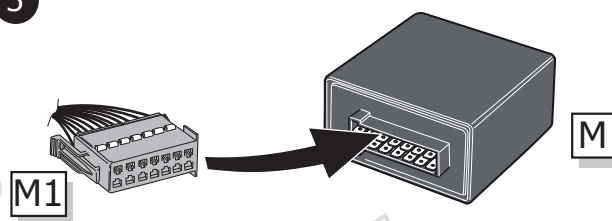

B

⚠ MAX = 21W

